

Chapter 10, survey (cadastral) systems, brings us into a realm that some might regard as marginal for students of folk and vernacular cultures. Several of the maps in this chapter, however, graphically depict a certain correspondence between early cadastral schemes and some persistent culture groups; further such evidence can be seen, as well, in Chapter 3, rural settlement, where still other significance appears. One of the principal residual influences of initial occupants lies in their priority in survey schemes; all subsequent development takes place on their base. Thus, knowing of the survey systems leads to greater appreciation of the details of local cultures.

A further interest, especially for students of contemporary cultures map arise from the adjustments to survey systems other than a certain group's own. People seem to have both conformed to and resisted the intentions of alien survey types. These varying responses seem to provide historic details for thesis testing, as well as for our ultimate objective.

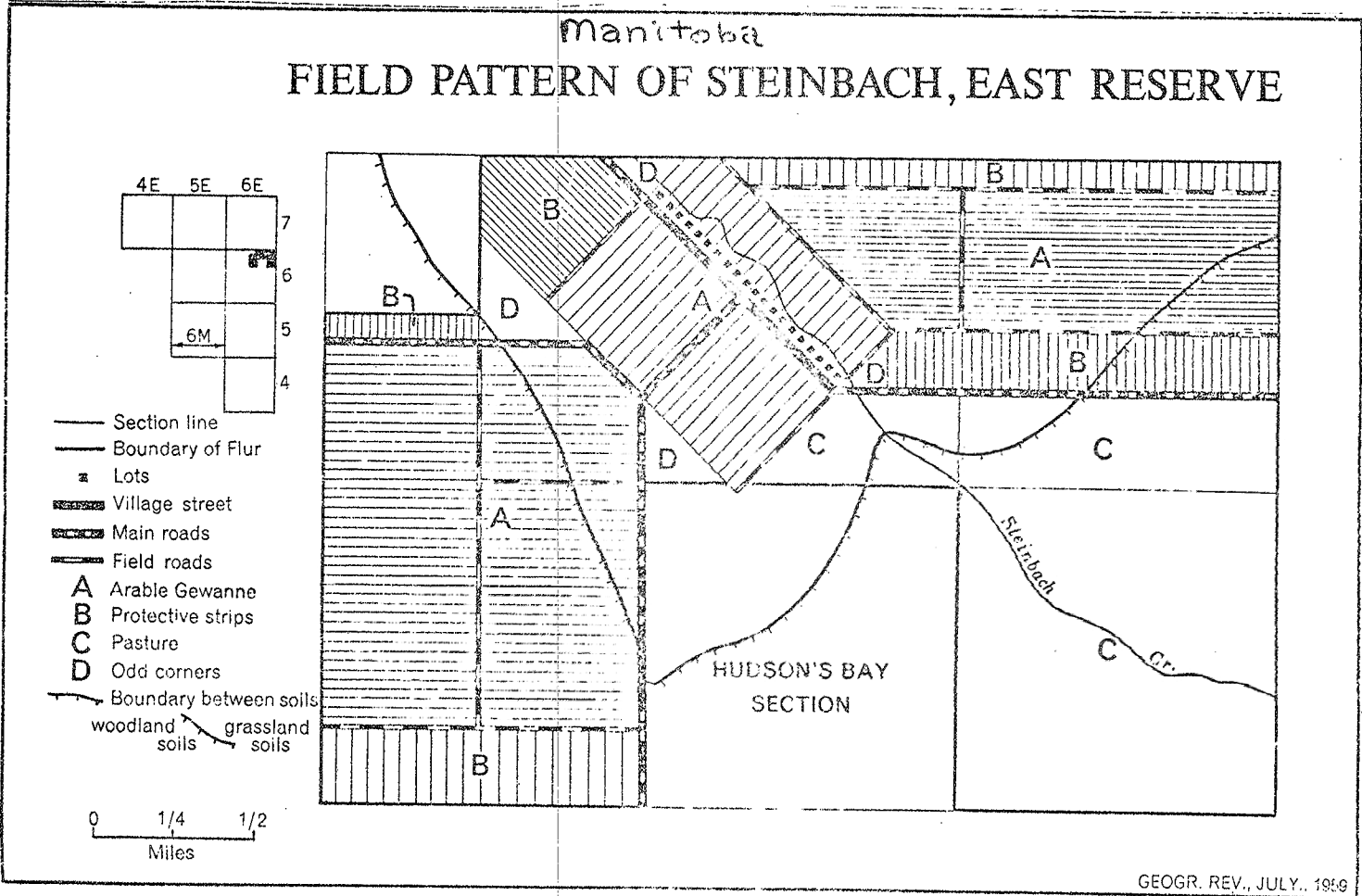

GEOGR. REV., JULY., 1959

FIG. 14—Field pattern of Steinbach. This map has been redrawn from a map compiled and copyrighted by Mr. J. C. Reimer of Steinbach and generously loaned by him (see also text footnote 1-). The Gewanne are precisely drawn, but the Kugel are approximate.

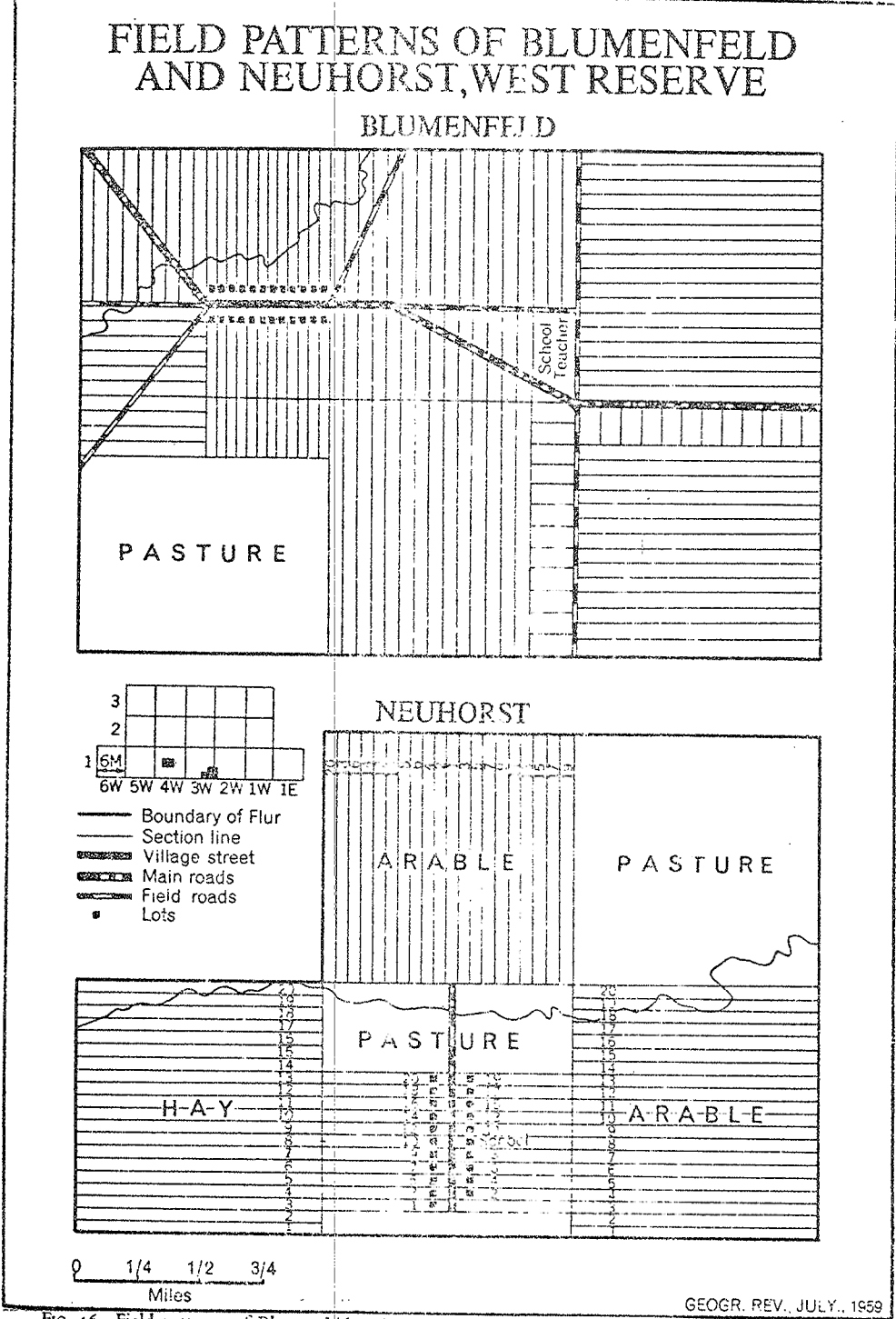

GEOGR. REV., JULY., 1959

FIG. 16—Field patterns of Blumenfeld and Neuhorst, West Reserve, showing arrangement of Gewanne and Kugel. Compare pattern of Blumenfeld with present pattern shown in Figure 17.

Warkentin
1959

FIGURE II
CADASTRE EN « PUZZLE » DANS FATIMA

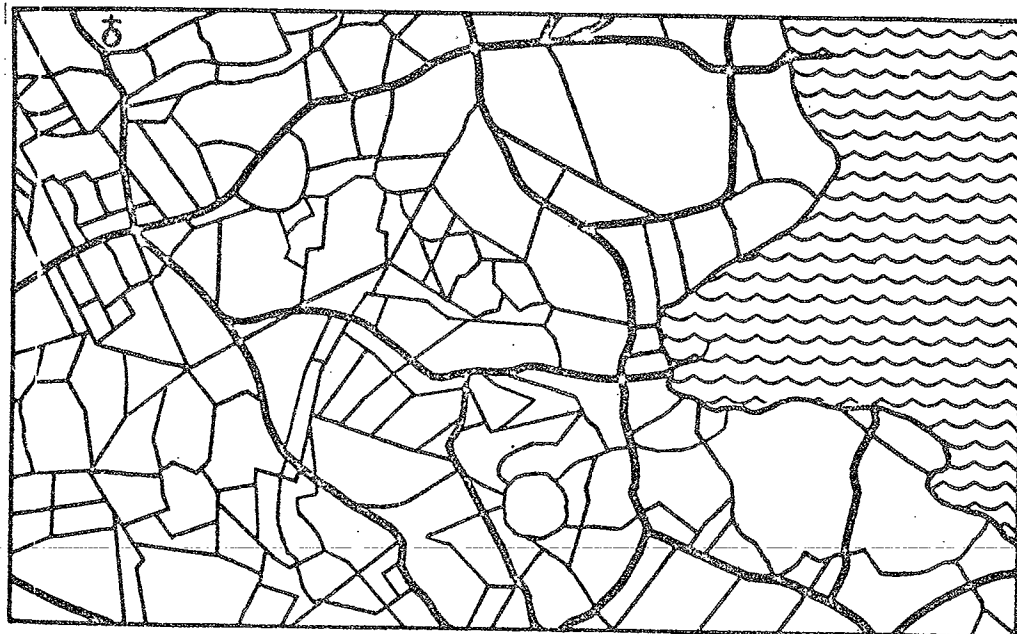

(échelle approximative 1 : 30,000)

On se croirait en présence d'un cadastre des régions méridionales de la France ; mais ici, l'habitat est dispersé dans les terres. Ce type de cadastre, qui se retrouve partout aux îles de la Madeleine, n'existe nulle part ailleurs au Canada.

Quebec

Falaise 1959

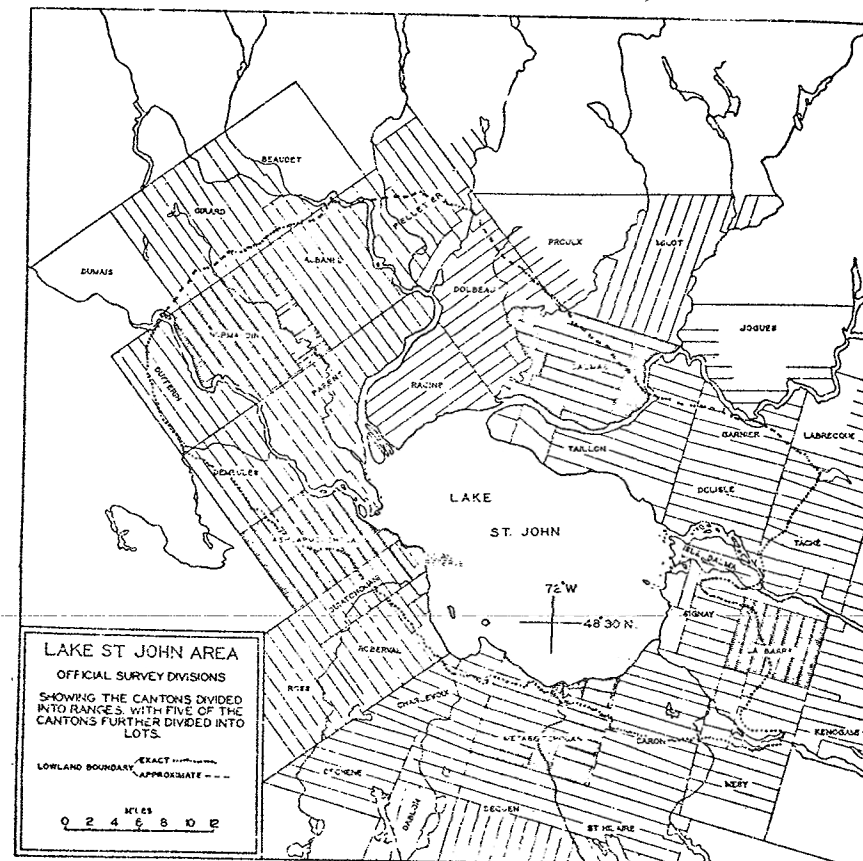
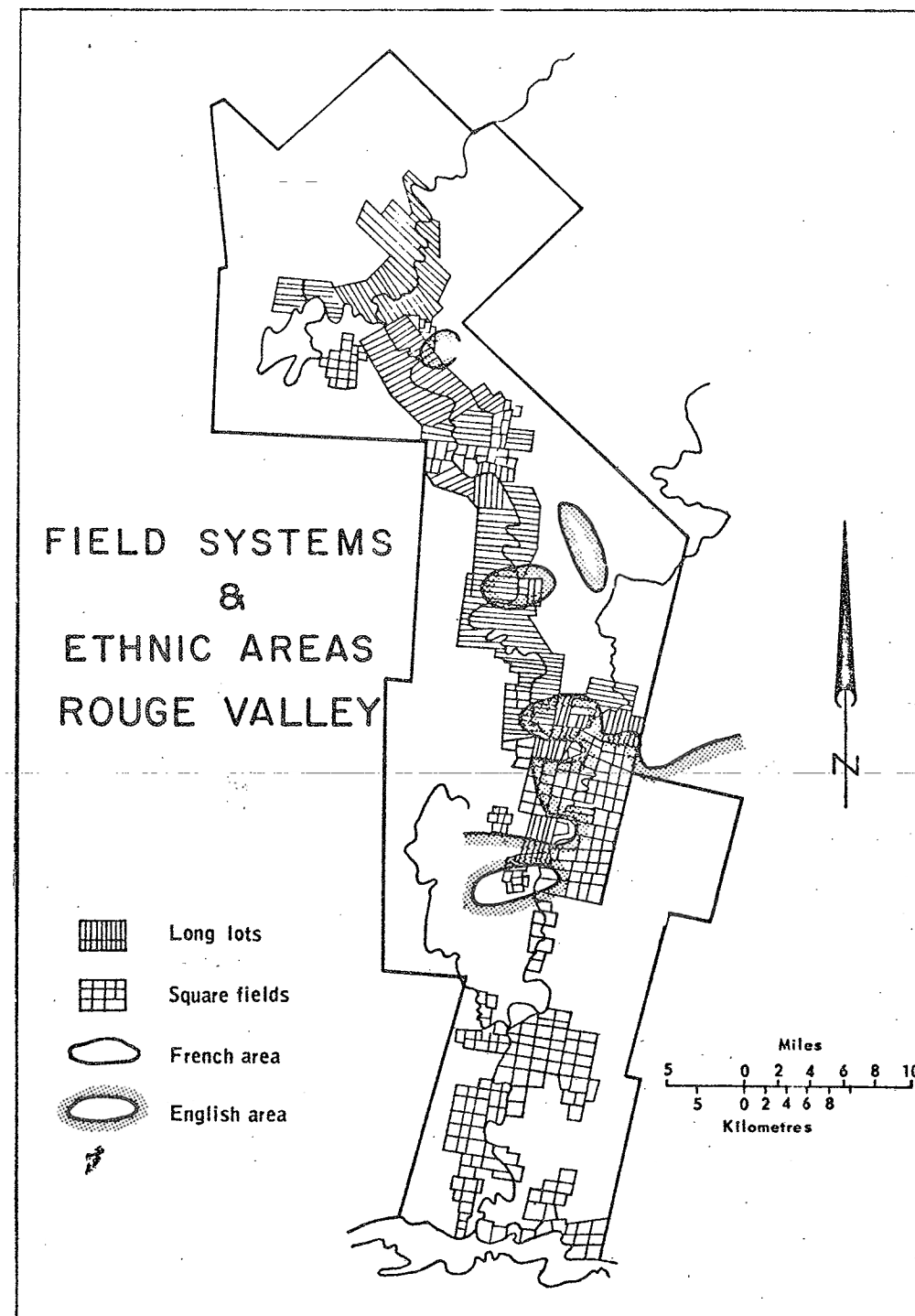

FIG. 4—Land division in the Lake St. John area. Based on the "Carte régionale du Lac St. Jean, comprenant les cantons arpentés," Department of Colonization, Mines, and Fisheries, Quebec, 1923 and 1929 issues.

Glendenning 1934



Frost 1969

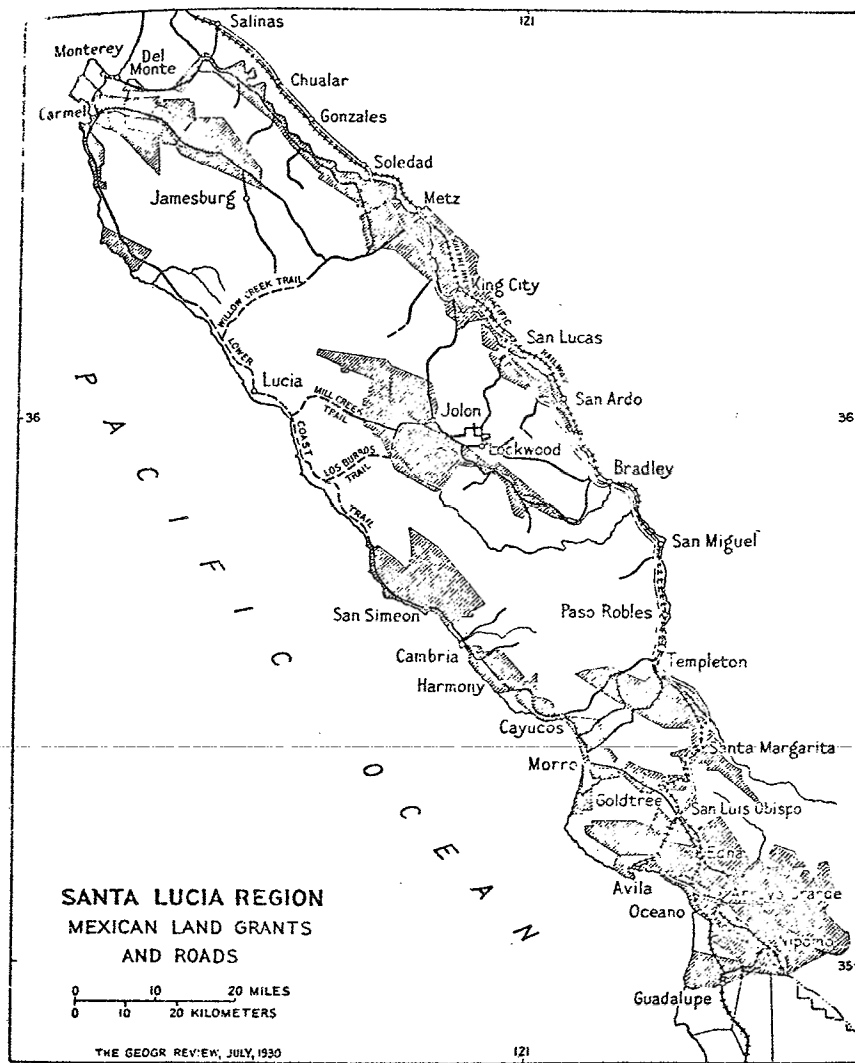
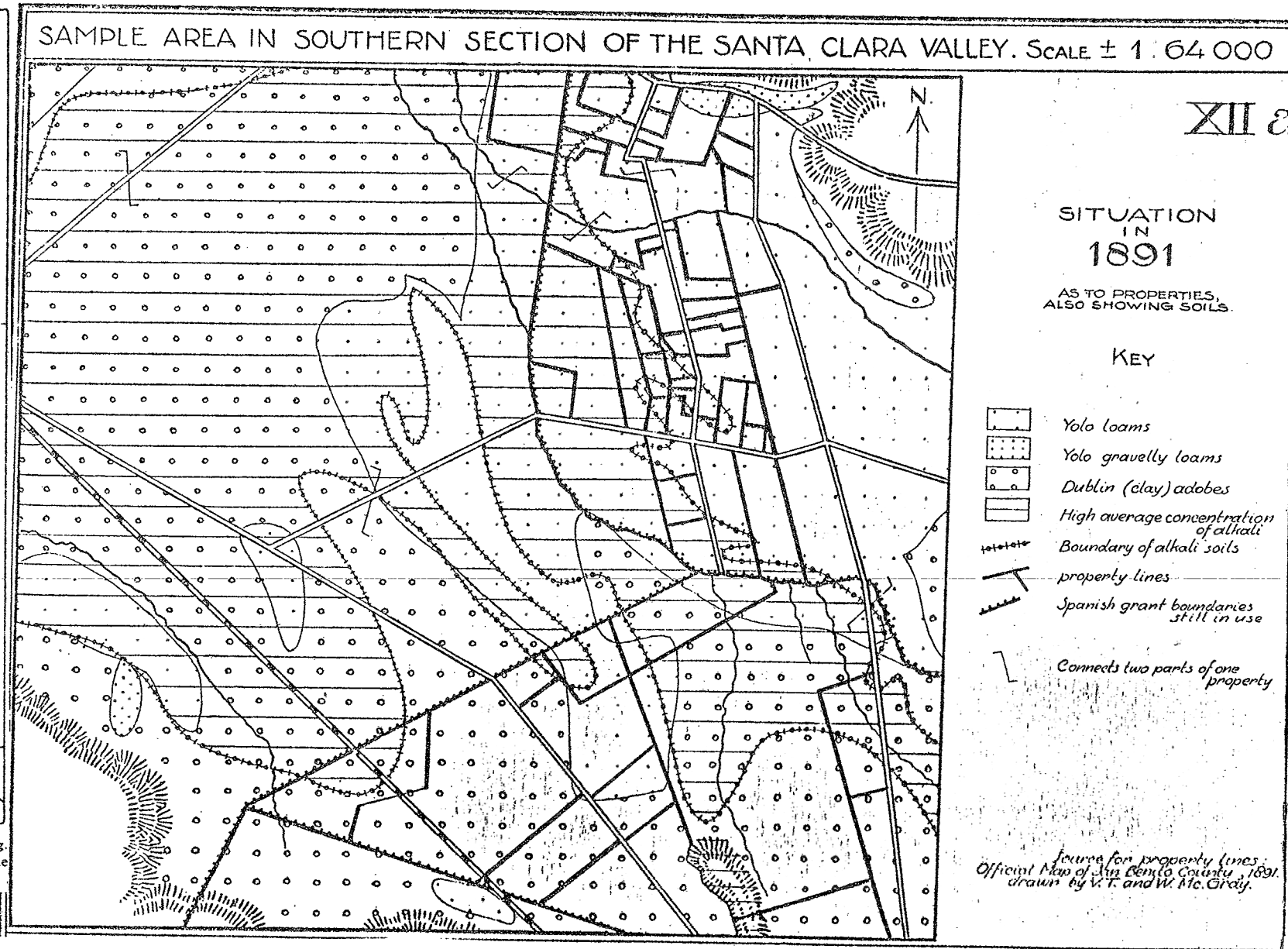
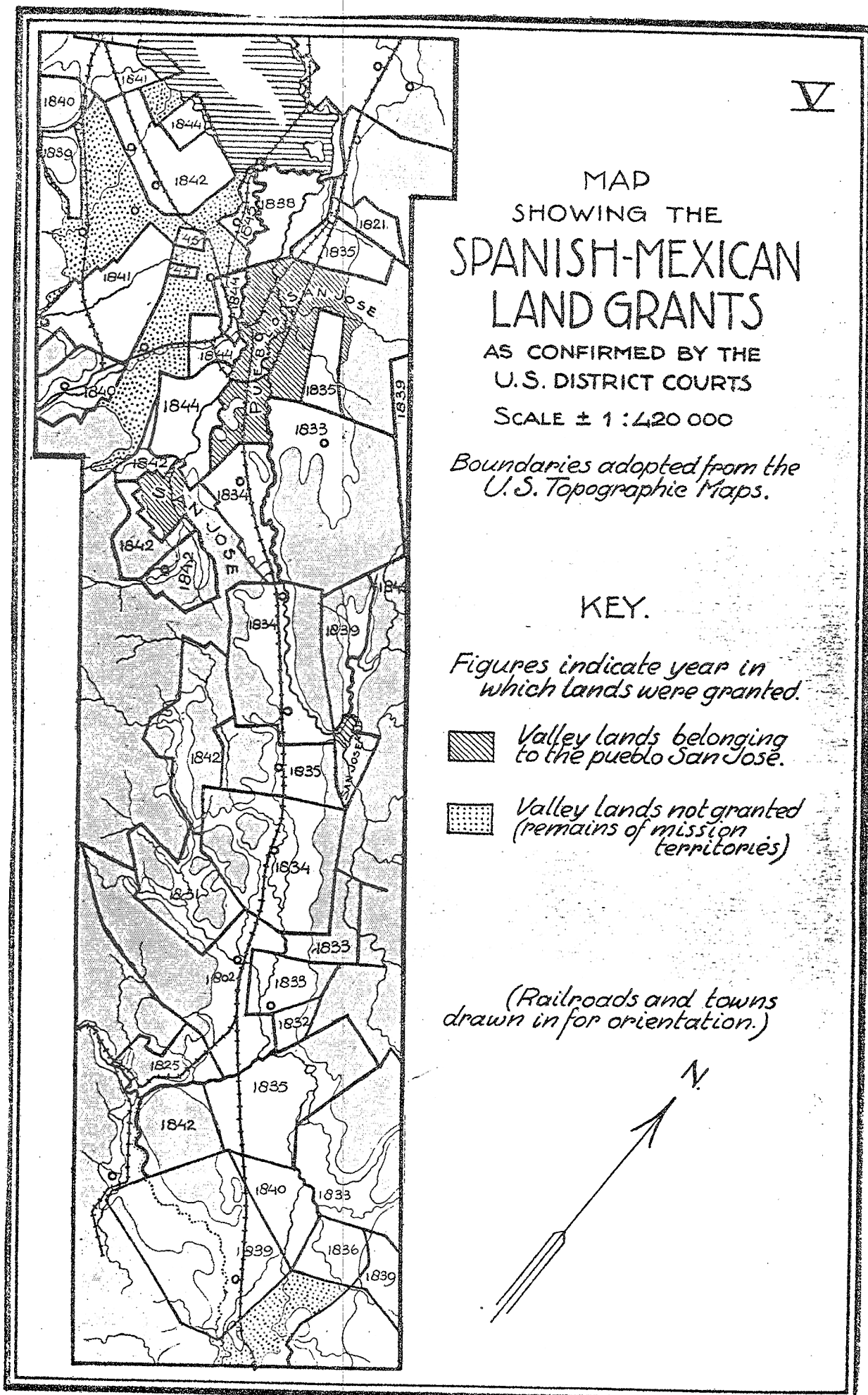

FIG. 4—The Santa Lucia region. The Mexican land grants for grazing are shown by shading. Railroads are shown by conventional symbol, state highways by double line, other roads by single line, trails by broken line.

Coulter 1930



Broek 1932



Broek 1932

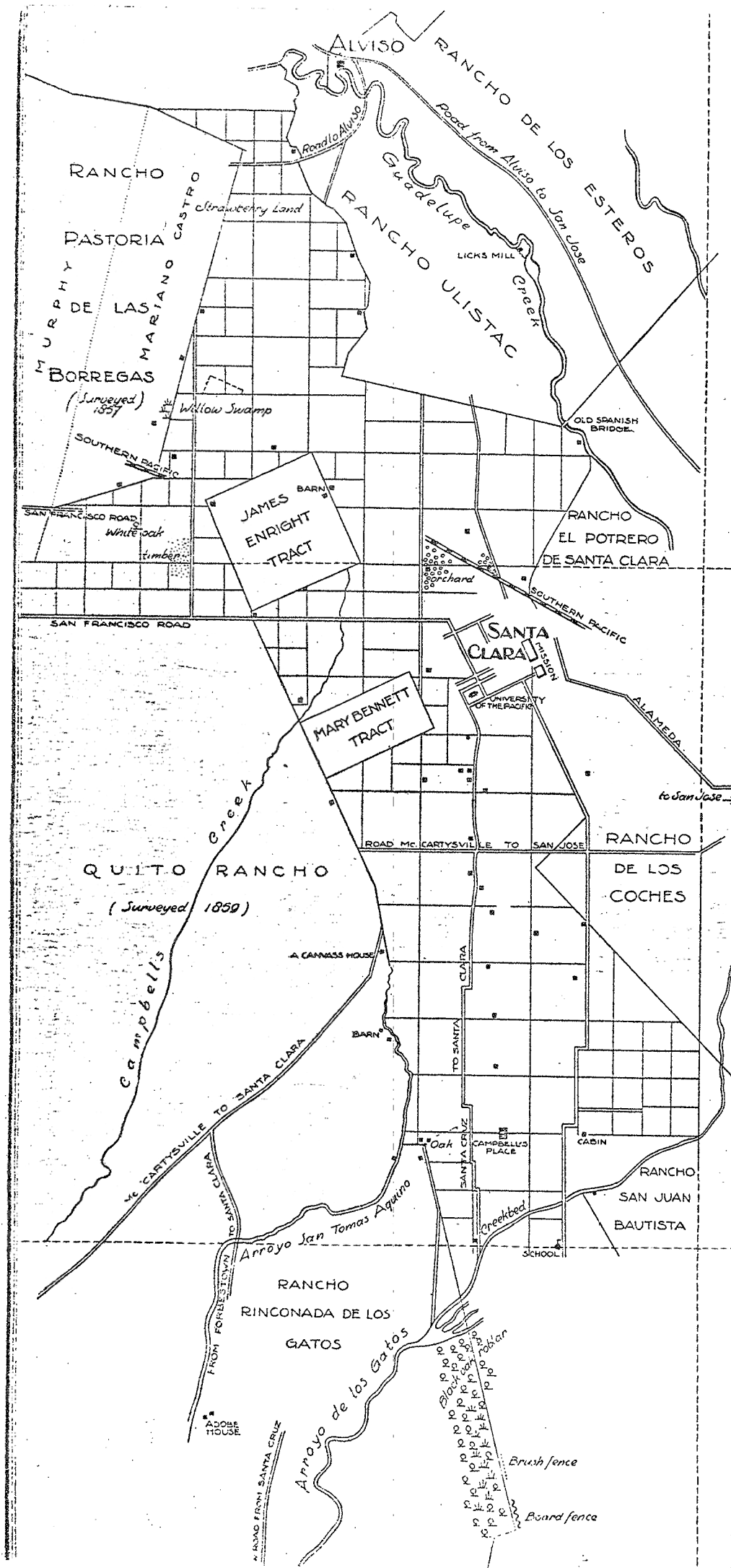

COMPOSED FROM OFFICIAL SURVEY
MAPS IN THE U S LAND OFFICE
SAN FRANCISCO

SCALE
1 INCH TO 2 1/2 MILES

Township N° 6, South
Range N° 1, West

Survey examined and approved
by Surveyor General, S. Francisco
May 12th 1866 (Surveyed 1851-1866)

Township N° 7, South
Range N° 1, West
Surveyed 1851-1866.

Broek 1932

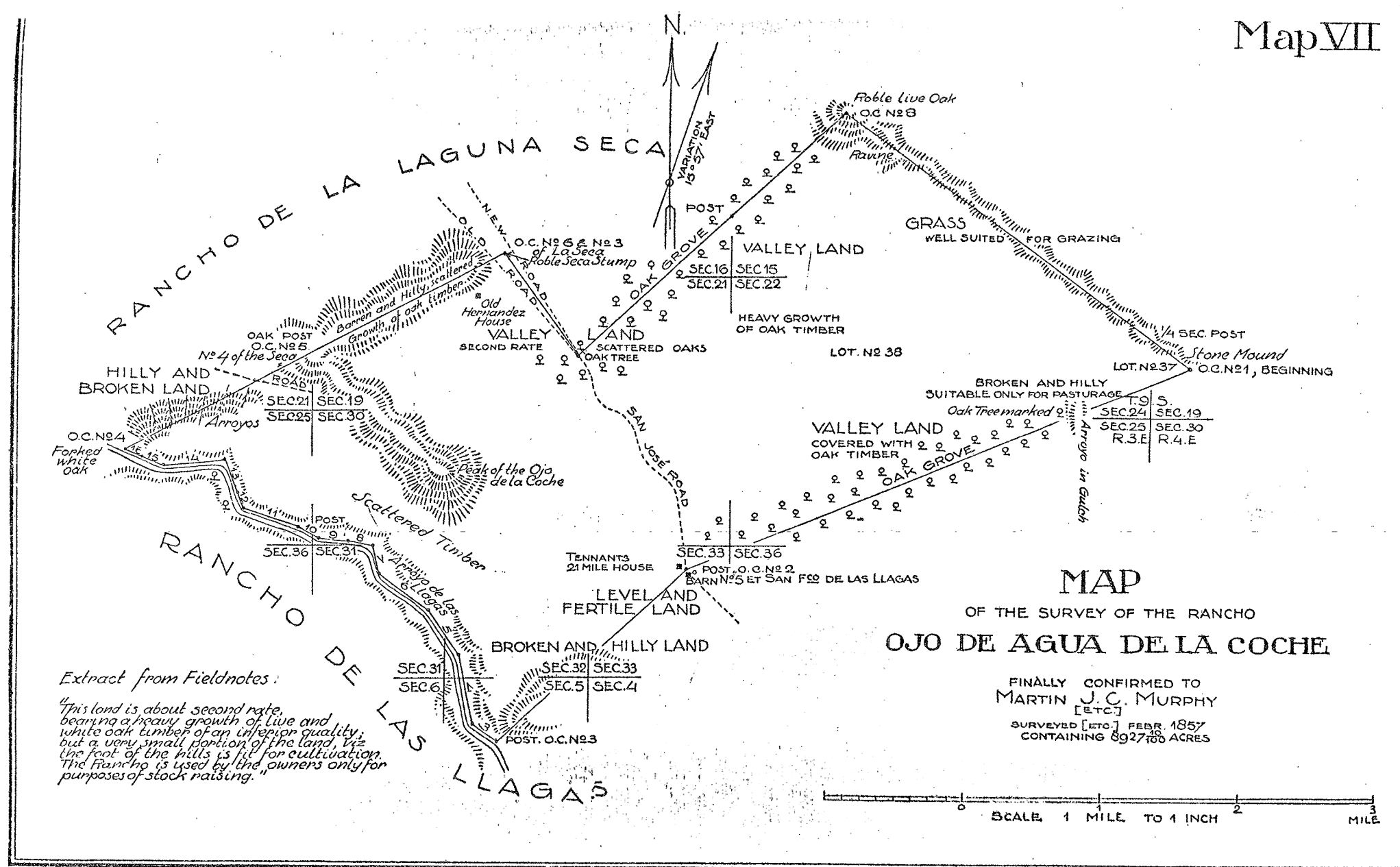

Broek 1932

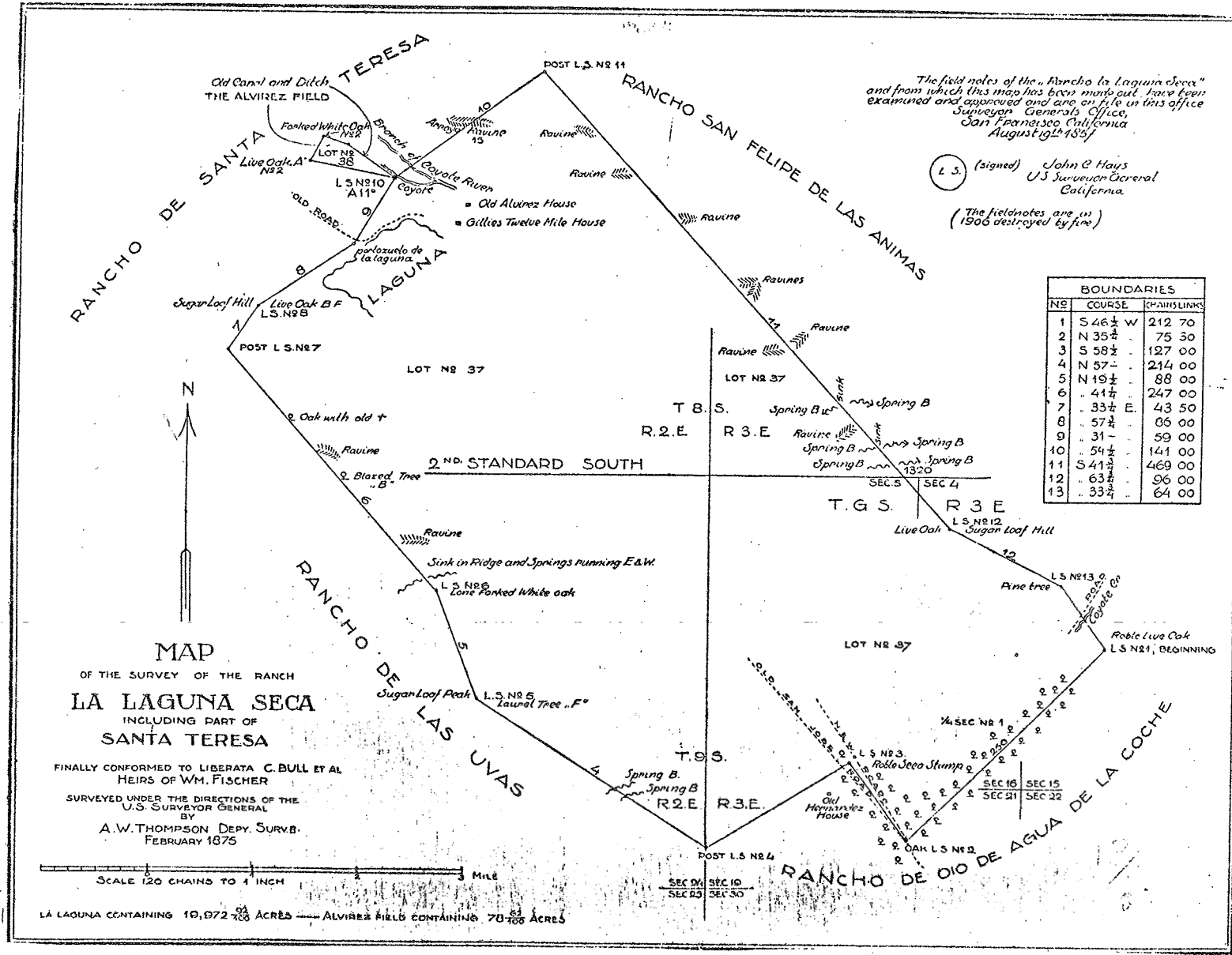

Broek 1932

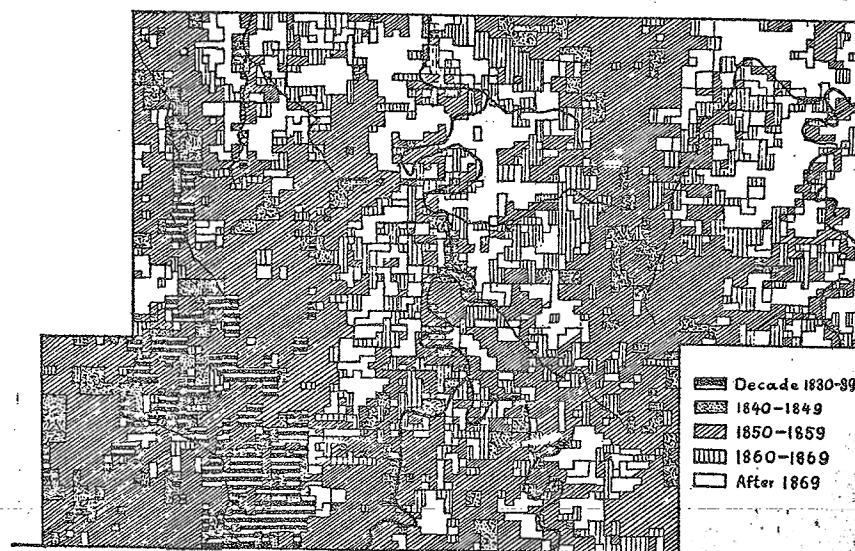

FIG. 26.—Order of land entries in Hickory County (prepared from *Land Entry Book*, County Clerk's Office, Hermitage). *Missouri.*

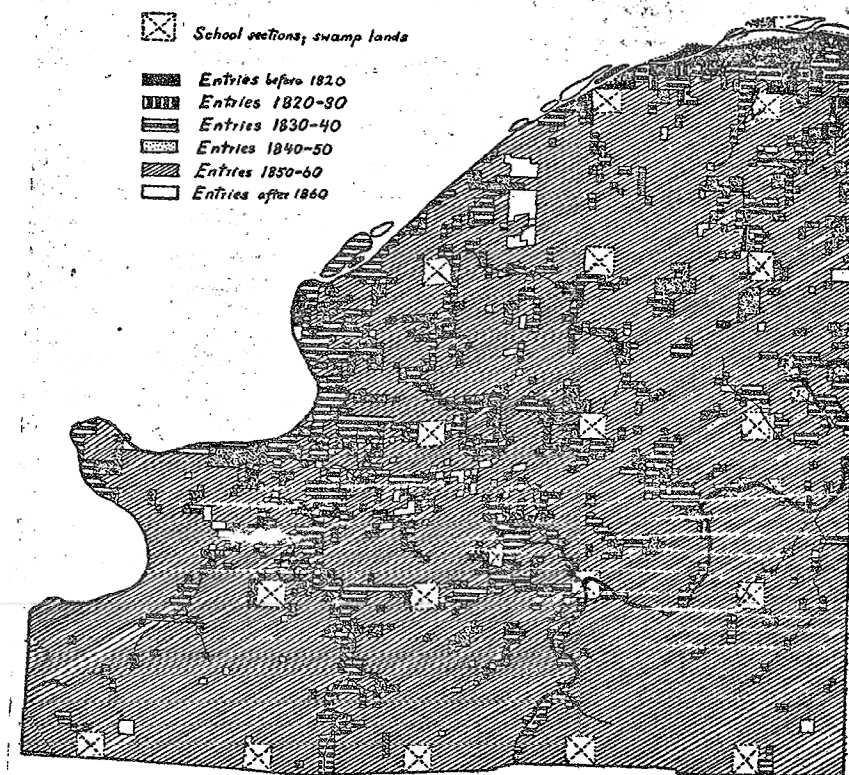
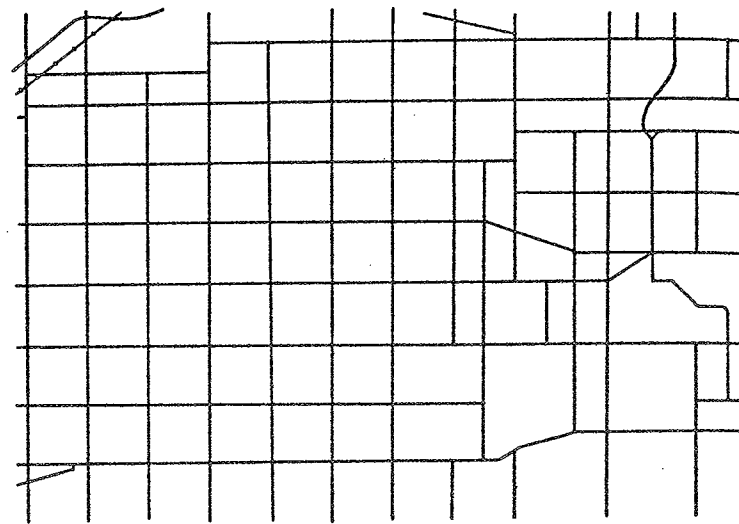
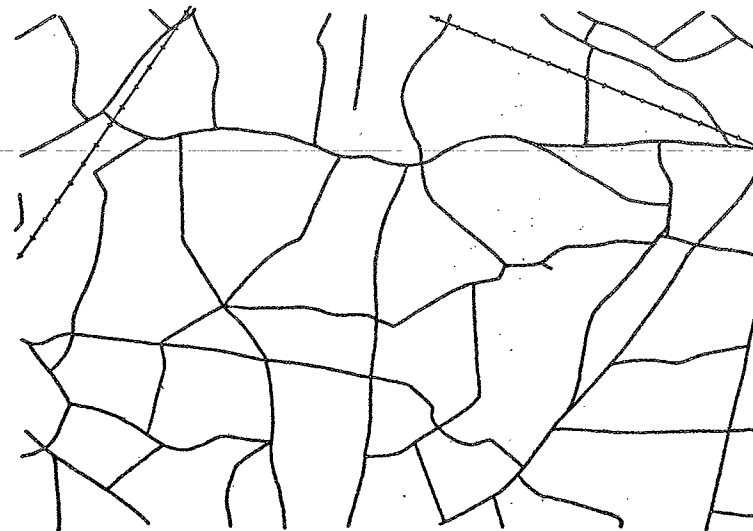

FIG. 25.—Order of land entries in Osage County (prepared from *Land Entry Book*, County Clerk's Office, Linn). *Missouri.*

Sauer 1920



— PUBLIC HIGHWAYS c. 1875
- - - RAILROADS c. 1875



Figures 1a and 1b. Public highways and railroads in the example areas, c. 1875.

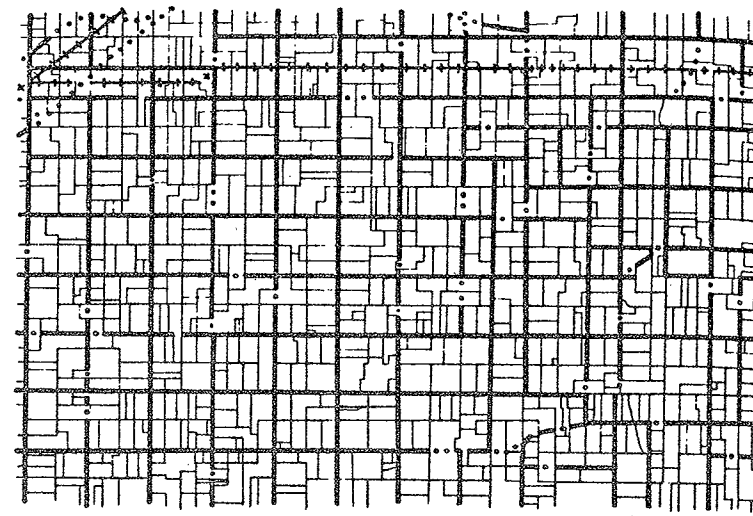

— PUBLIC HIGHWAY AND PROPERTY LINE c. 1955, COINCIDENT.
• • • • • PUBLIC HIGHWAY AND PROPERTY LINE c. 1955, NOT COINCIDENT.
+ + + + + RAILROAD AND PROPERTY LINE c. 1955, COINCIDENT.
* * * * * RAILROAD AND PROPERTY LINE c. 1955, NOT COINCIDENT.

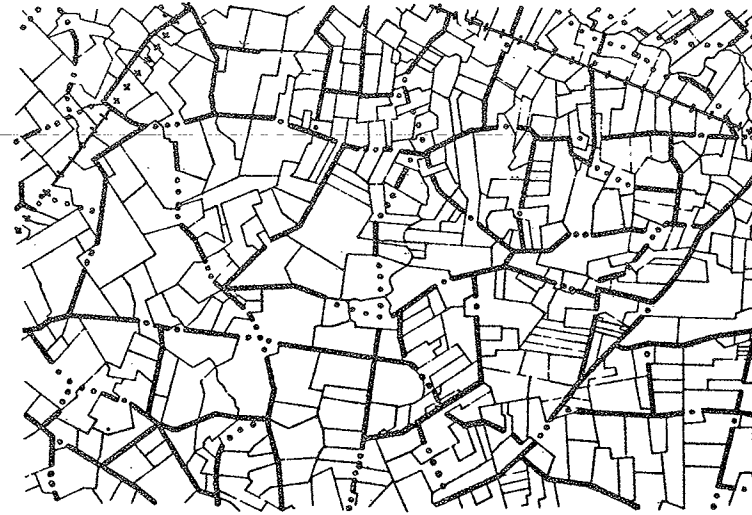

Figures 3a and 3b. Relationship of transportation lines and property boundaries in the example areas, c. 1955.

Ohio

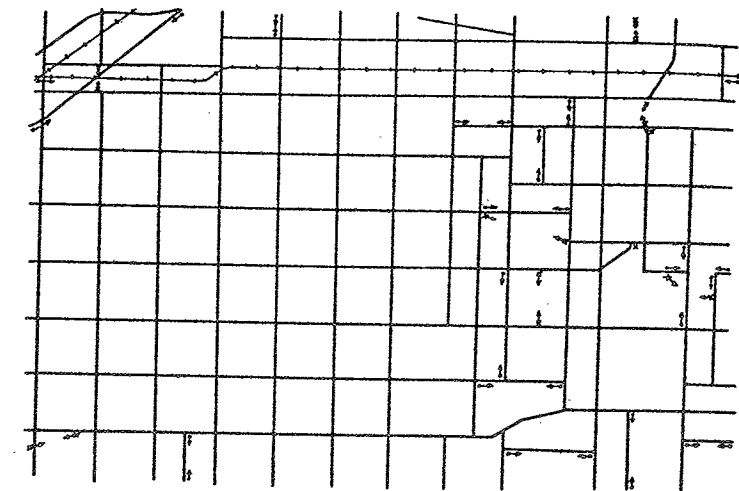

— PUBLIC HIGHWAYS c. 1955; — HIGHWAYS ADDED 1875 - 1955; - - - HIGHWAYS ABANDONED 1875 - 1955
+ + + RAILROADS c. 1955; - - - RAILROADS ADDED 1875 - 1955.

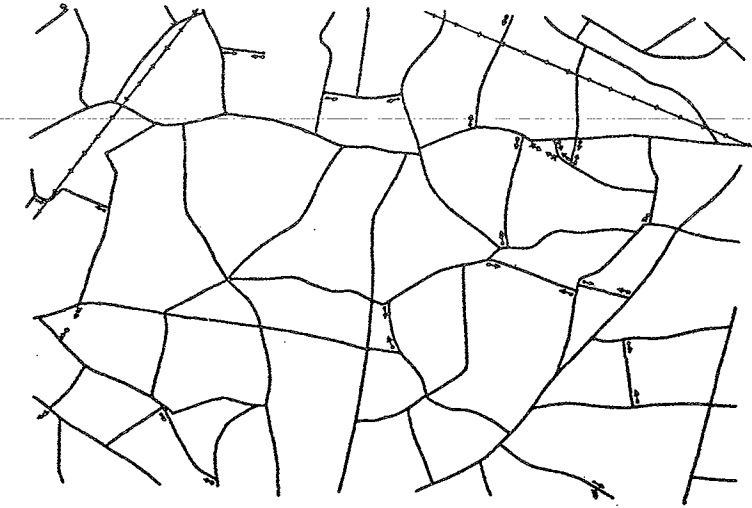

Figures 2a and 2b. Public highways and railroads in the example areas, c. 1955.

Thrower 1966

ST. HELENA PARISH SETTLED LAND, 1819

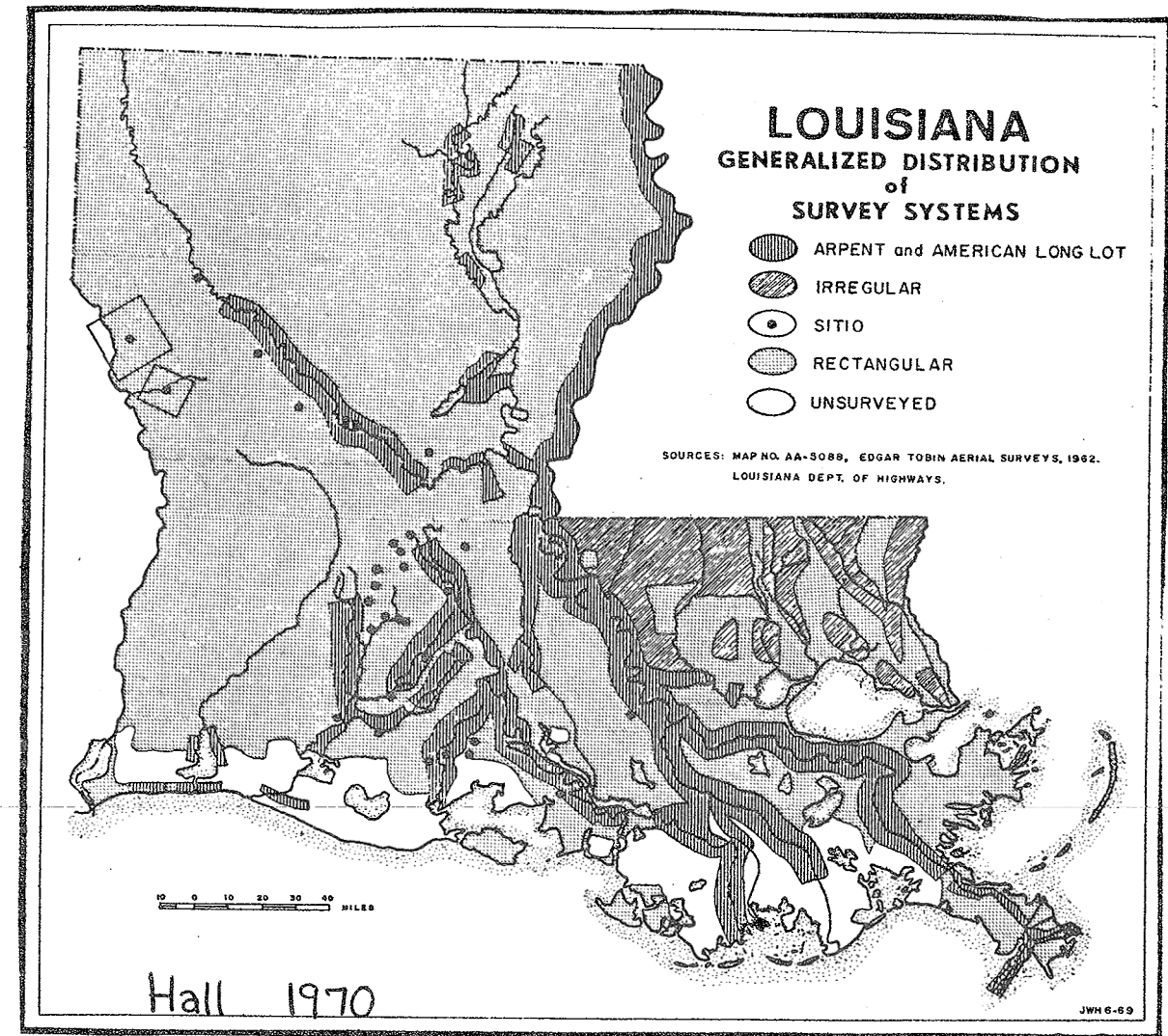
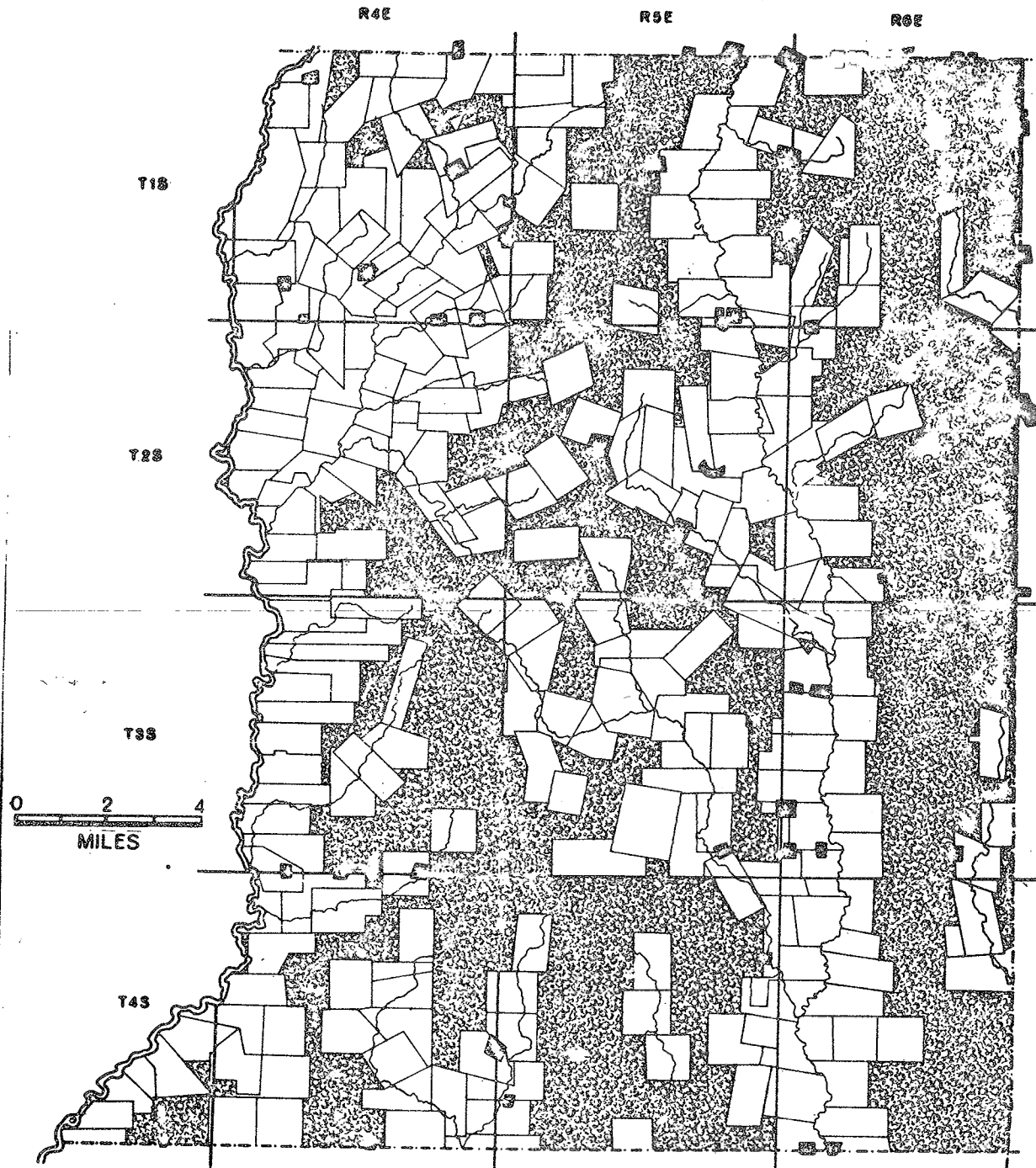

Newton 1967



LAND SETTLED BY 1819 AND SUBSEQUENTLY PATENTED



LOCATIONS OF FIELDS, GENERAL LAND OFFICE MAPS, 1845-48