

CHAPTER III - STRUCTURES

Total number of maps 38

Canada	1
U.S.A.	1
New Mexico	1
Missouri	2
Wisconsin	2
Louisiana	5
Tennessee	14
North Carolina	1
Pennsylvania	1
New England	10

Maps of house and barn types are most prevalent in the additional collection since Scratch I. The South is again well-represented particularly Tennessee, Louisiana, and the Missouri Ozarks. Some of the deficiencies found in this category in Scratch I have been overcome by Lewis' maps of the Connecticut River Valley house types and the Pillsbury and Kardos maps of New England houses. In addition, Bastian's maps of barn types in Wisconsin helps fill a gap for the Upper Midwest.

Gritzner's study of material culture in the Southwest has given us some insight to that cultural "sinkhole". Folk bridges are covered by the Gildea and Weber studies.

Deficiencies still remain for much of the Midwest, West, and Canada as well as the absence of maps illustrating modern structures.

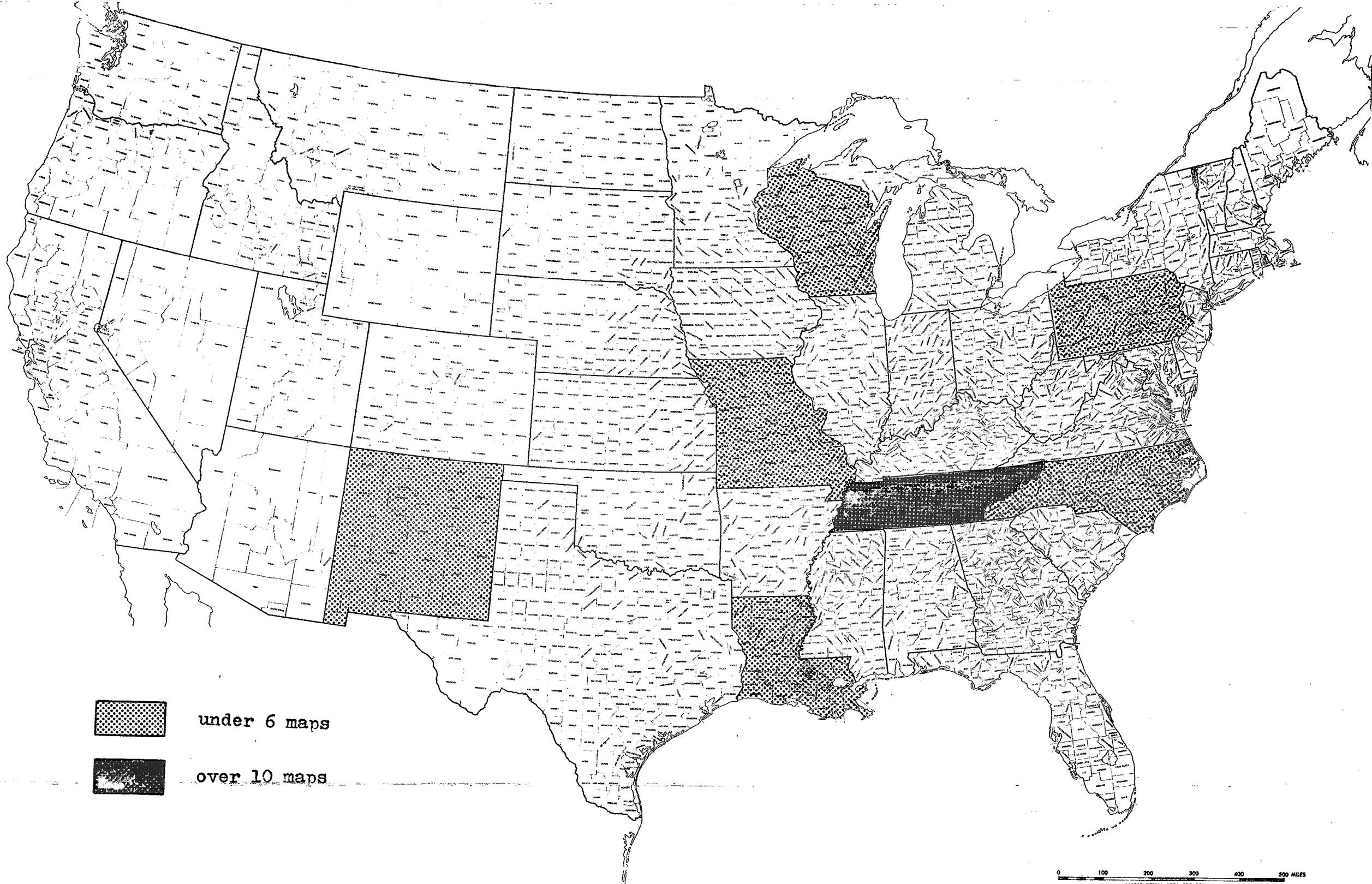

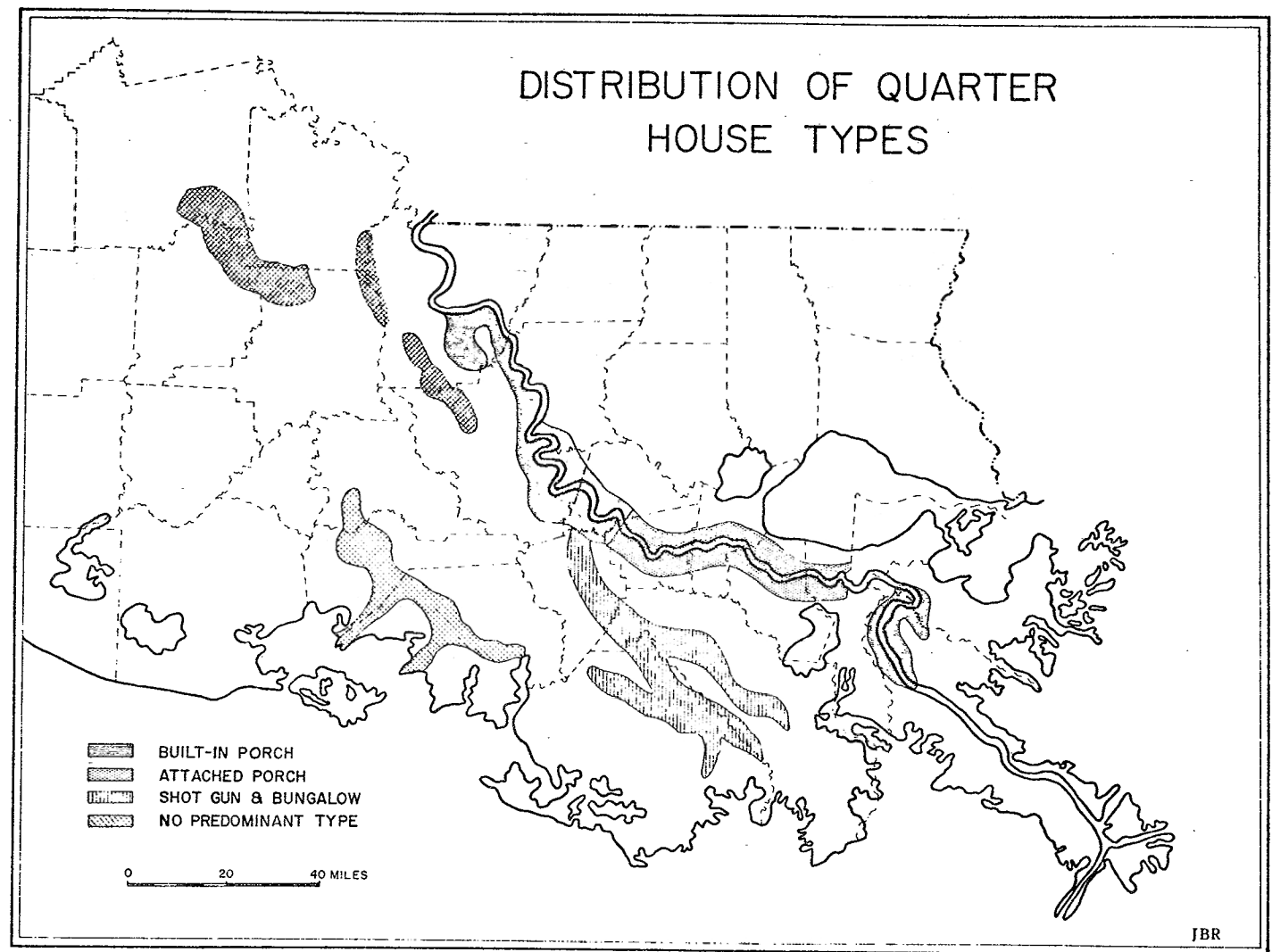

Map 23. Distribution of quarter house types - 1969.

Rehder 1971

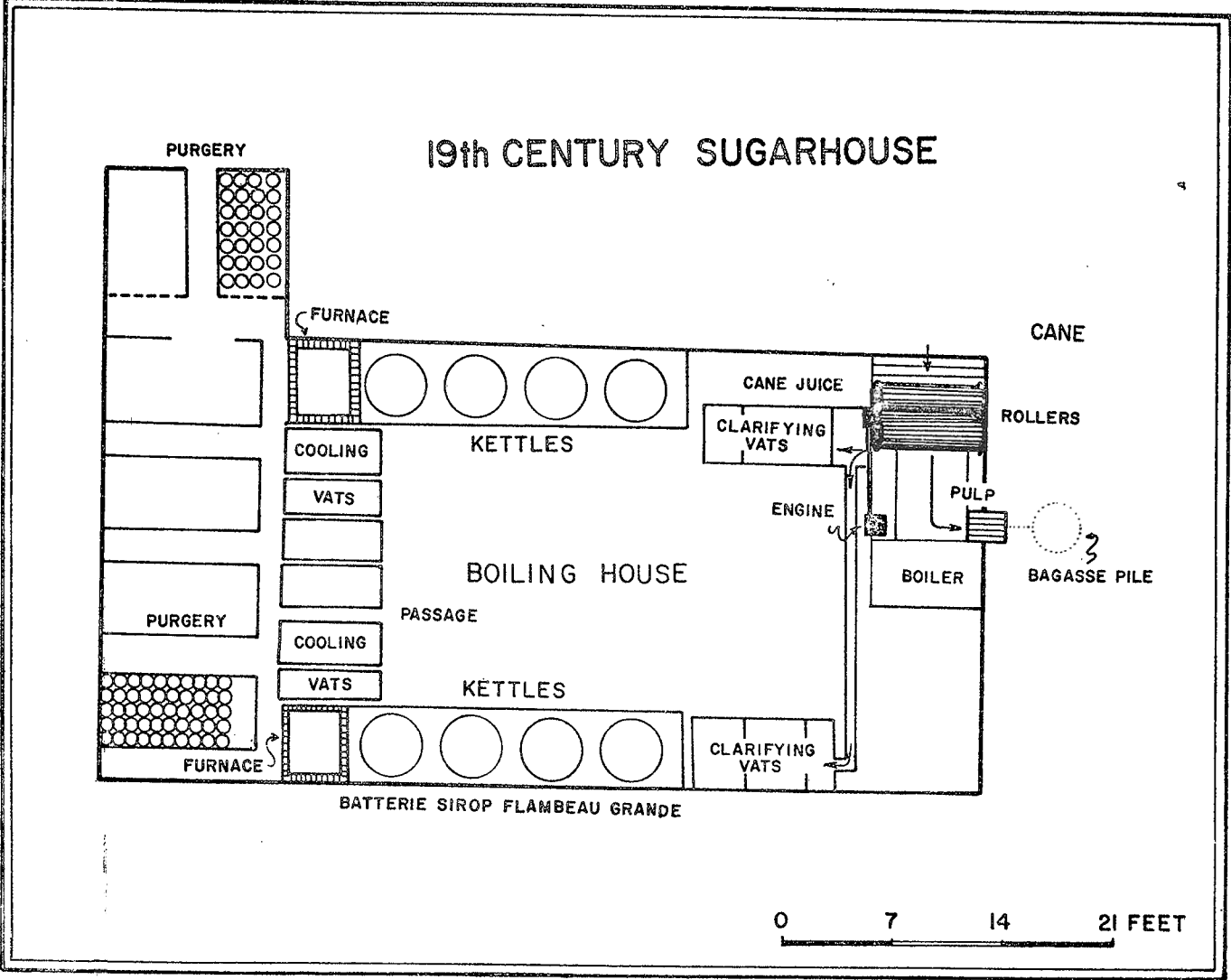

Floor plan and apparatus in a 19th century sugarhouse compiled from Benjamin Silliman, Manual.

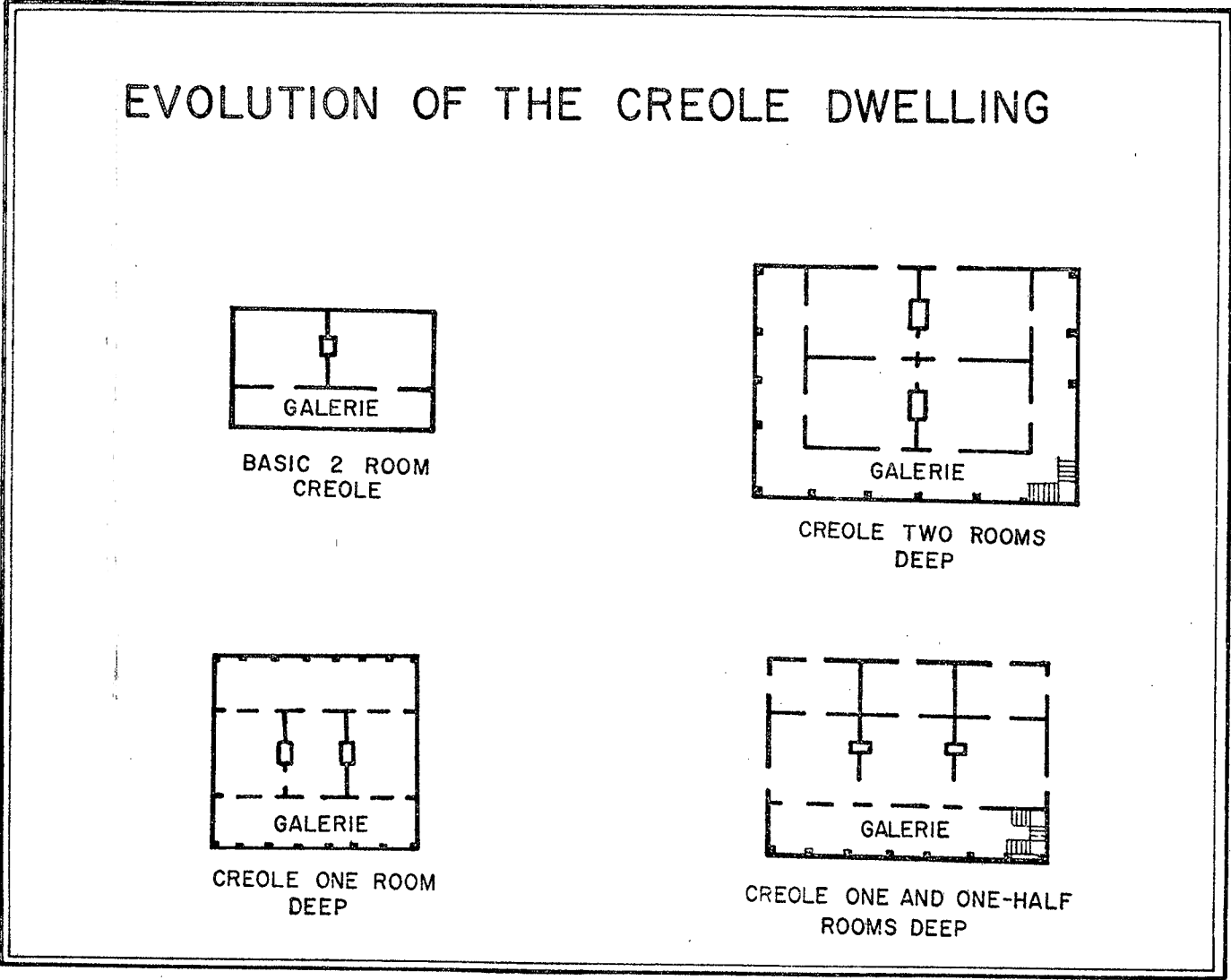

Evolution of the Creole dwelling as indicated by floor plans. After J. Frazer Smith, White Pillars and William B. Knipmeyer, "Settlement Succession."

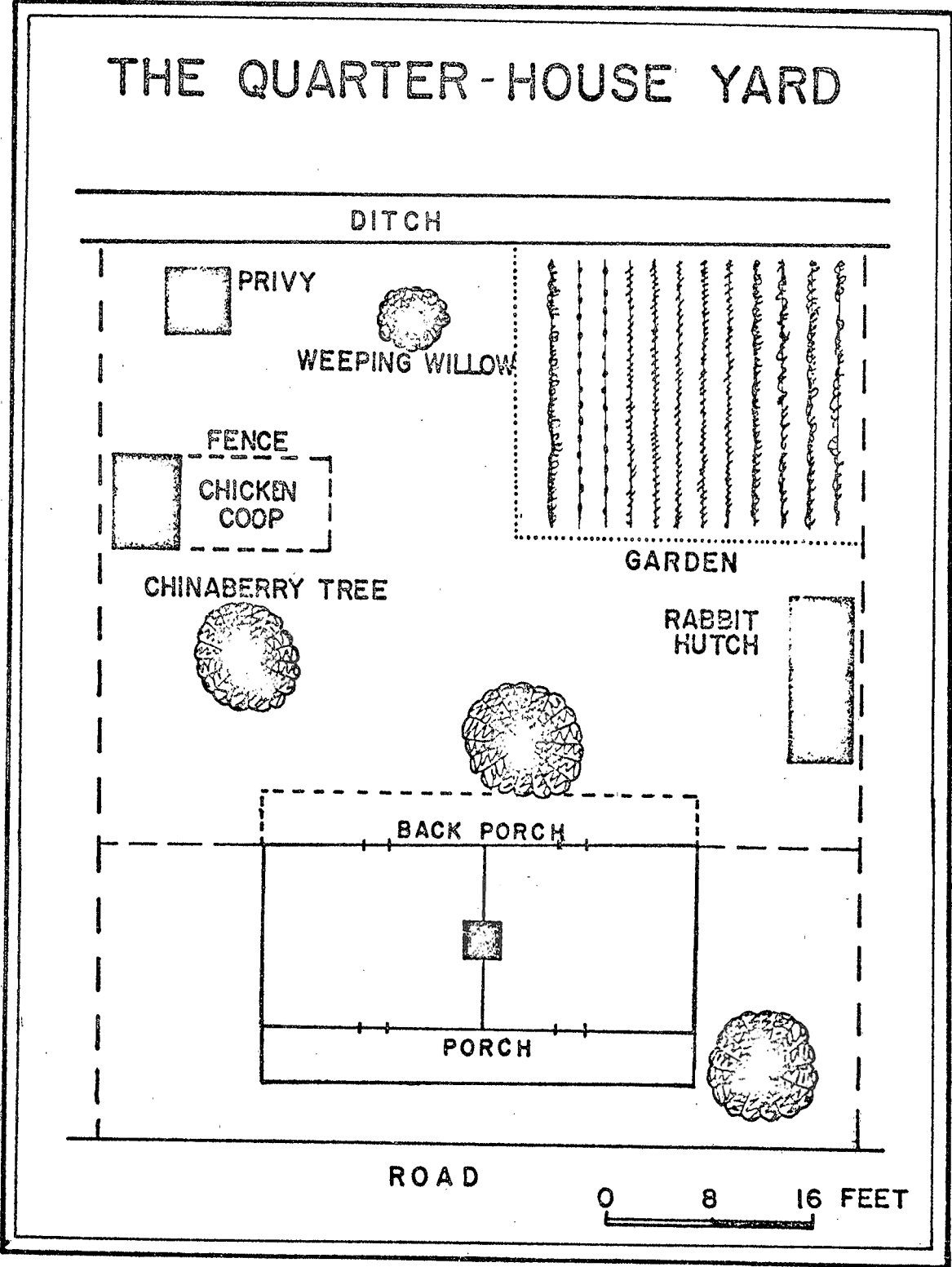
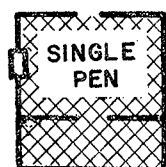

Fig. 74. Generalized composite of a quarter-house yard.

EVOLUTION OF THE ANGLO-AMERICAN DWELLING

BASIC SINGLE PEN



DOG TROT

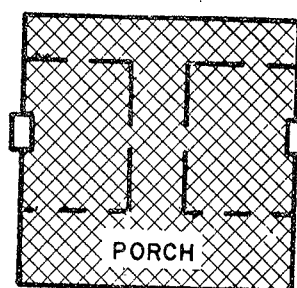

"I" HOUSE

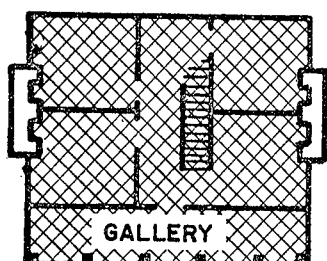
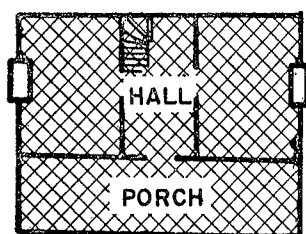

FOUR PEN BIG HOUSE

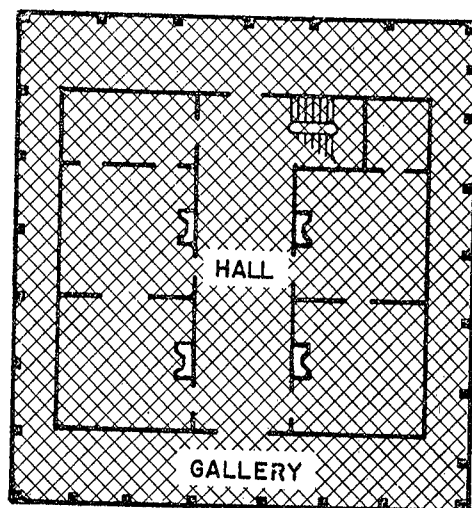

Evolution of the Upland Anglo-American dwelling as indicated by floor plans. After J. Frazer Smith, White Pillars.

Evolution of New England Housing

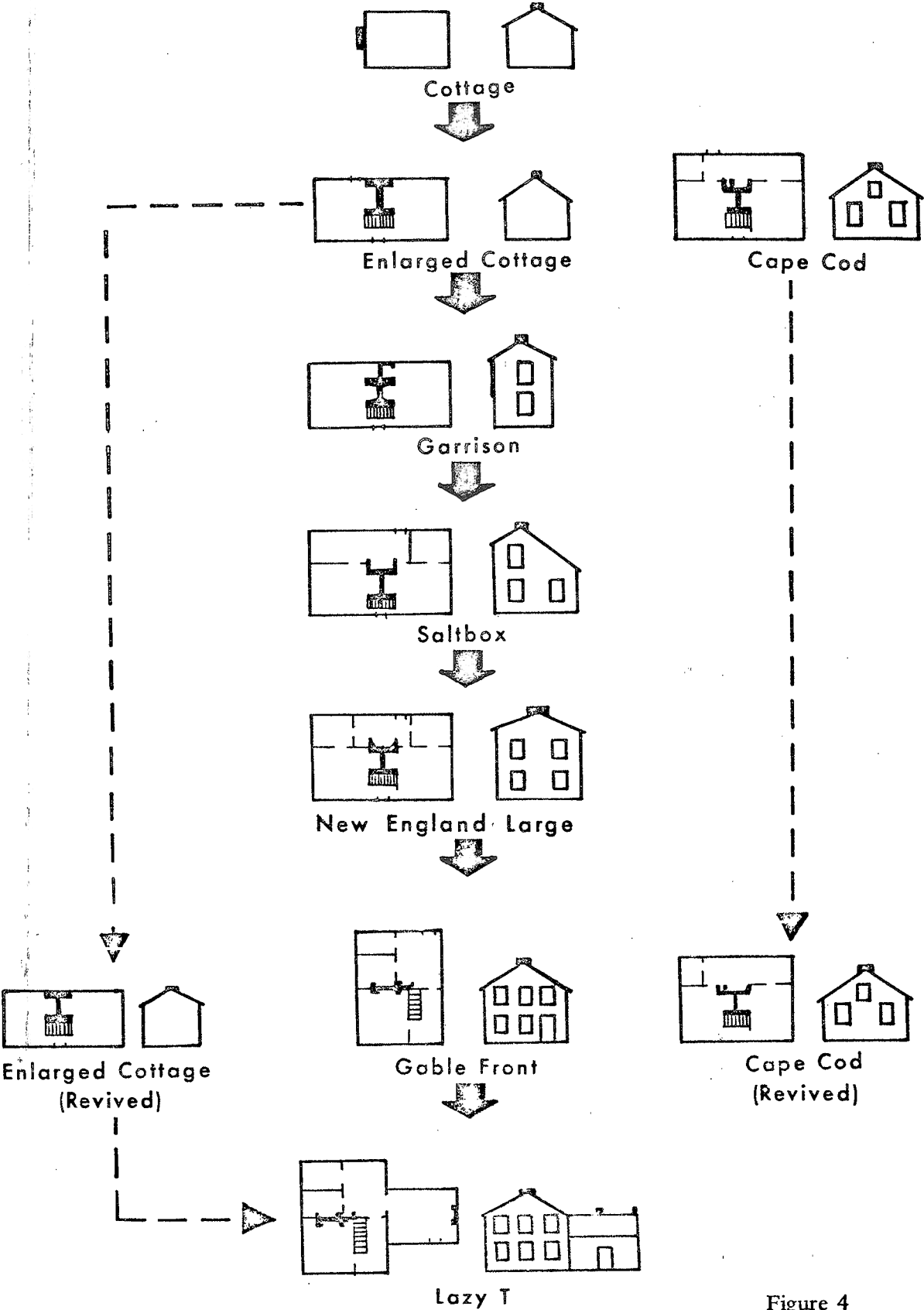

Figure 4

Evolution of Pennsylvania Housing

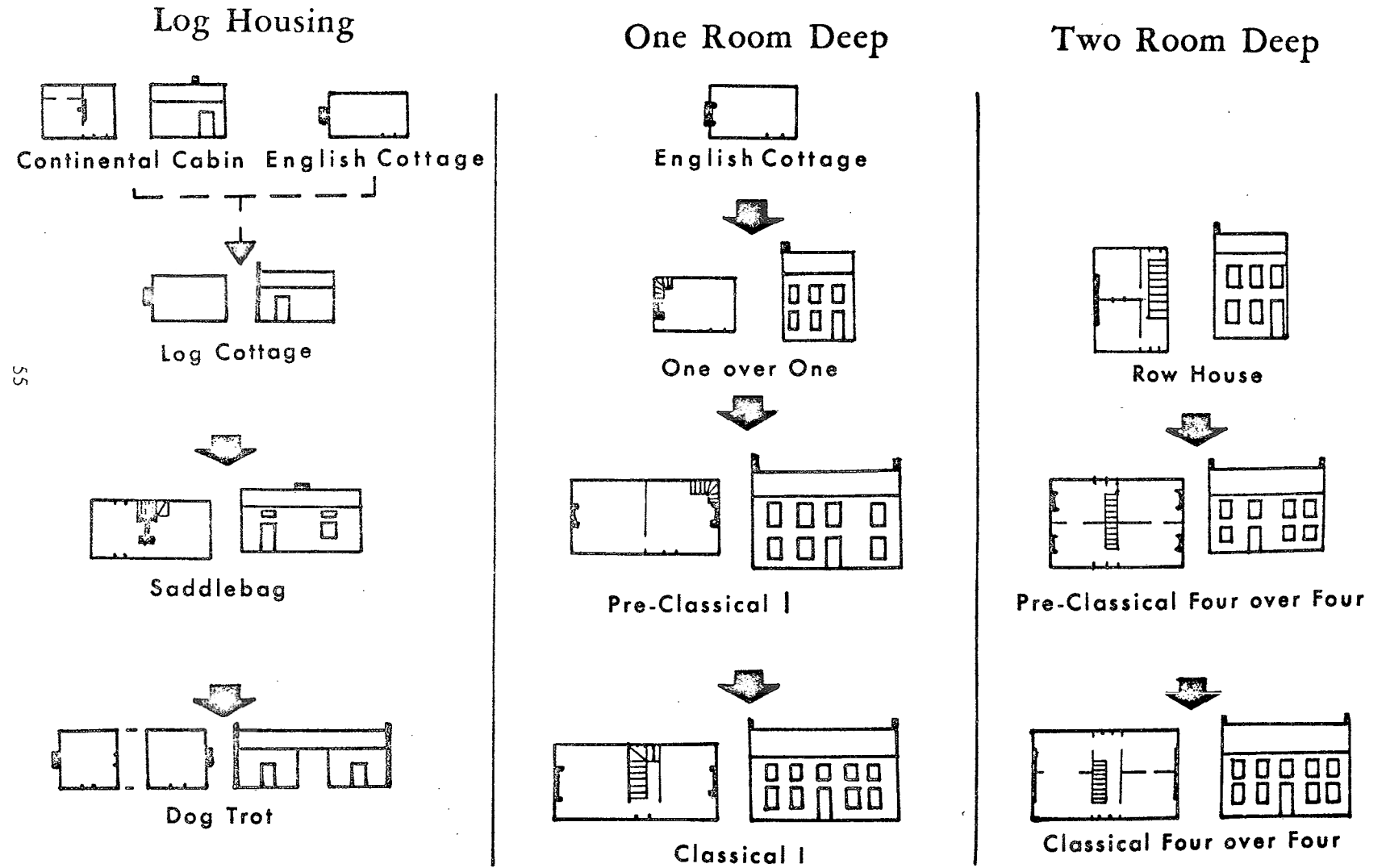

Figure 21

R

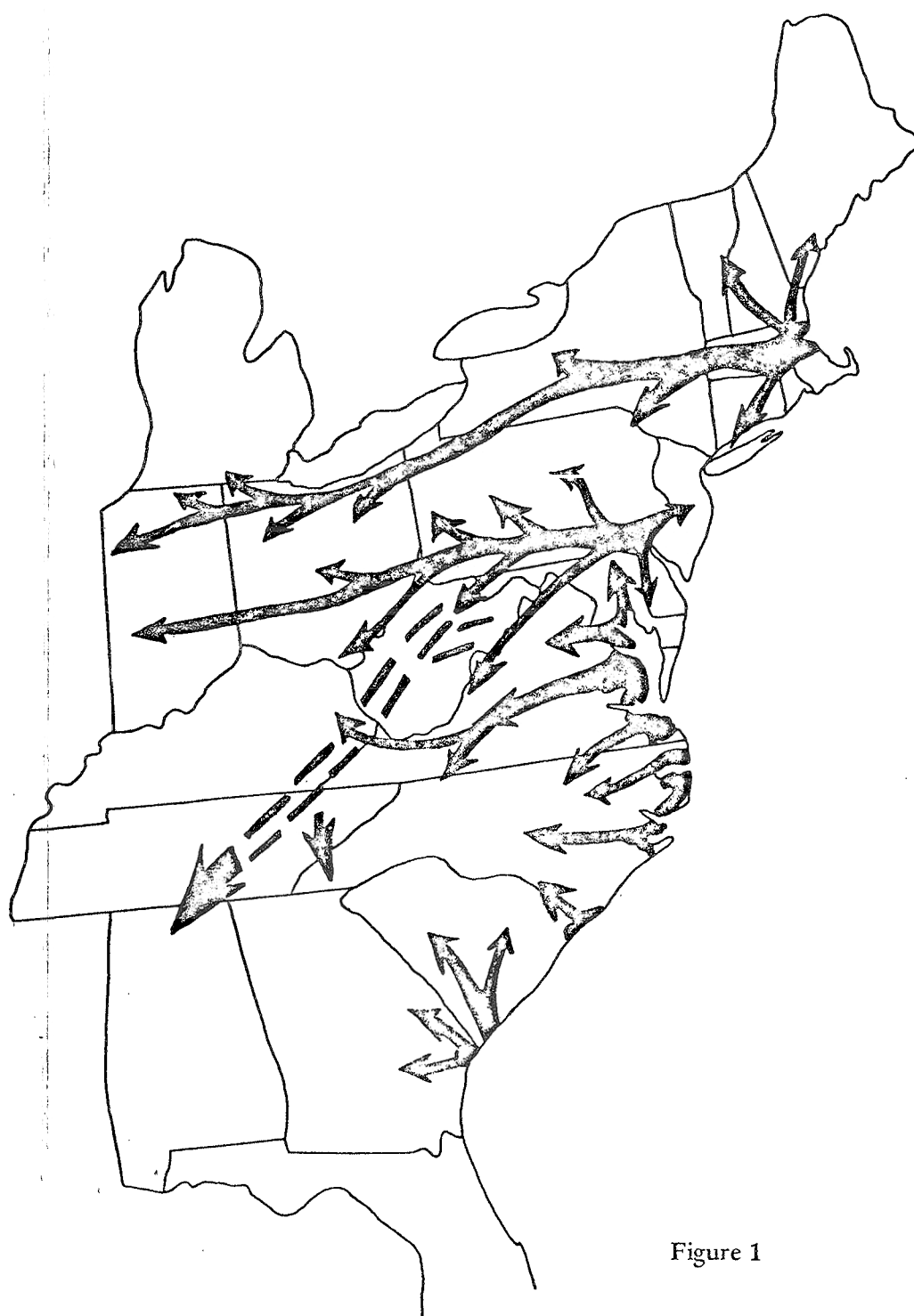
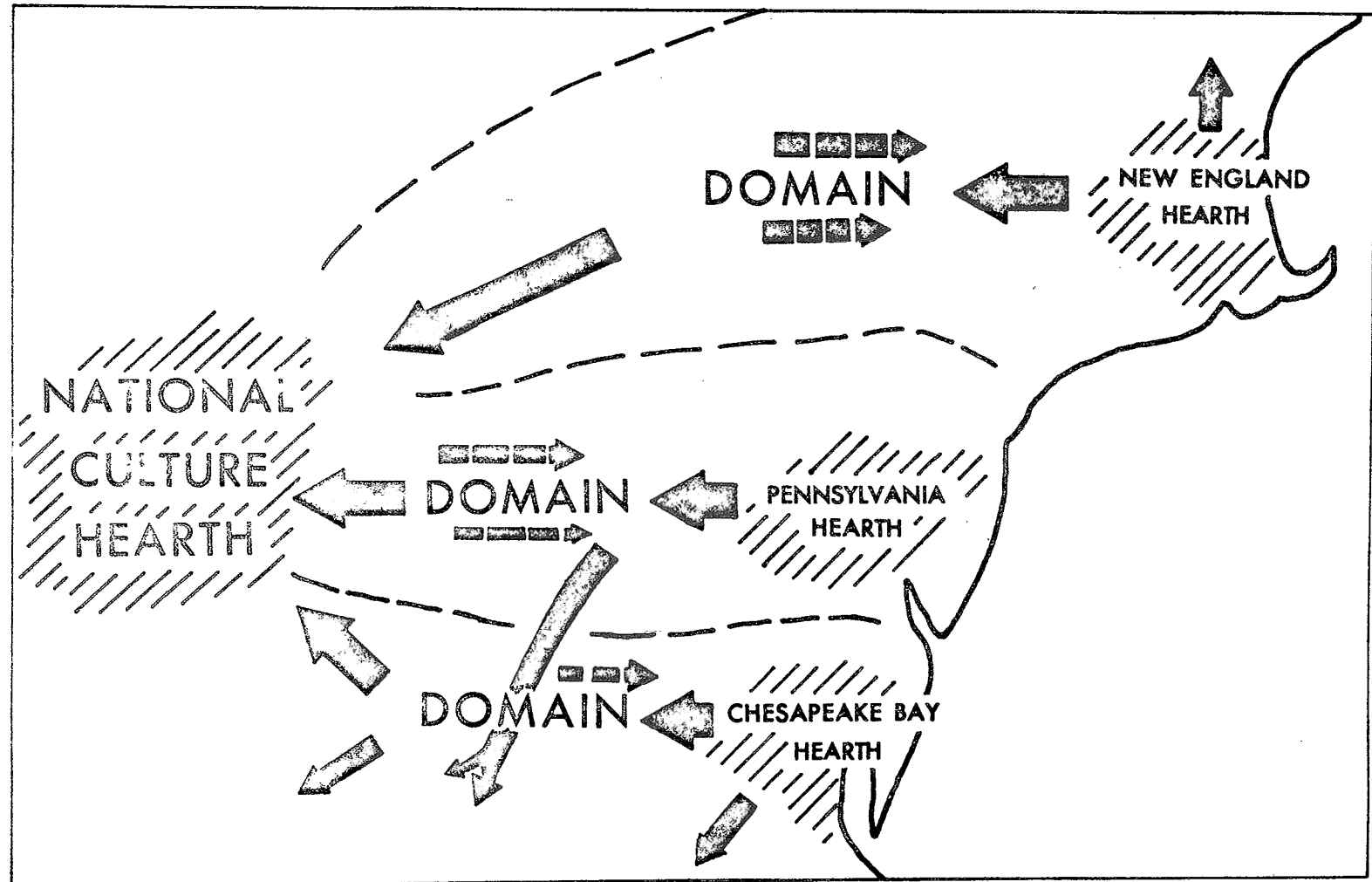
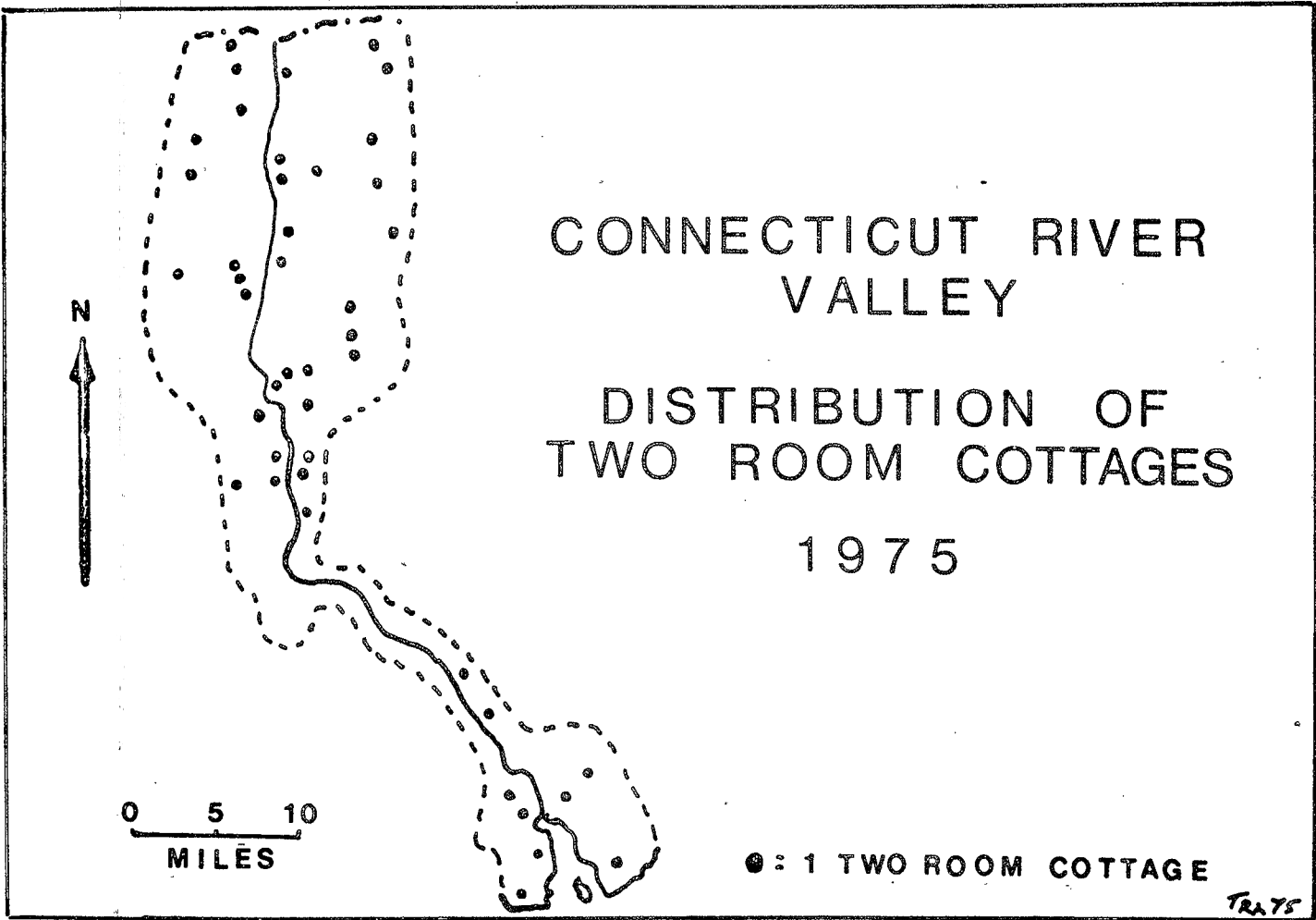
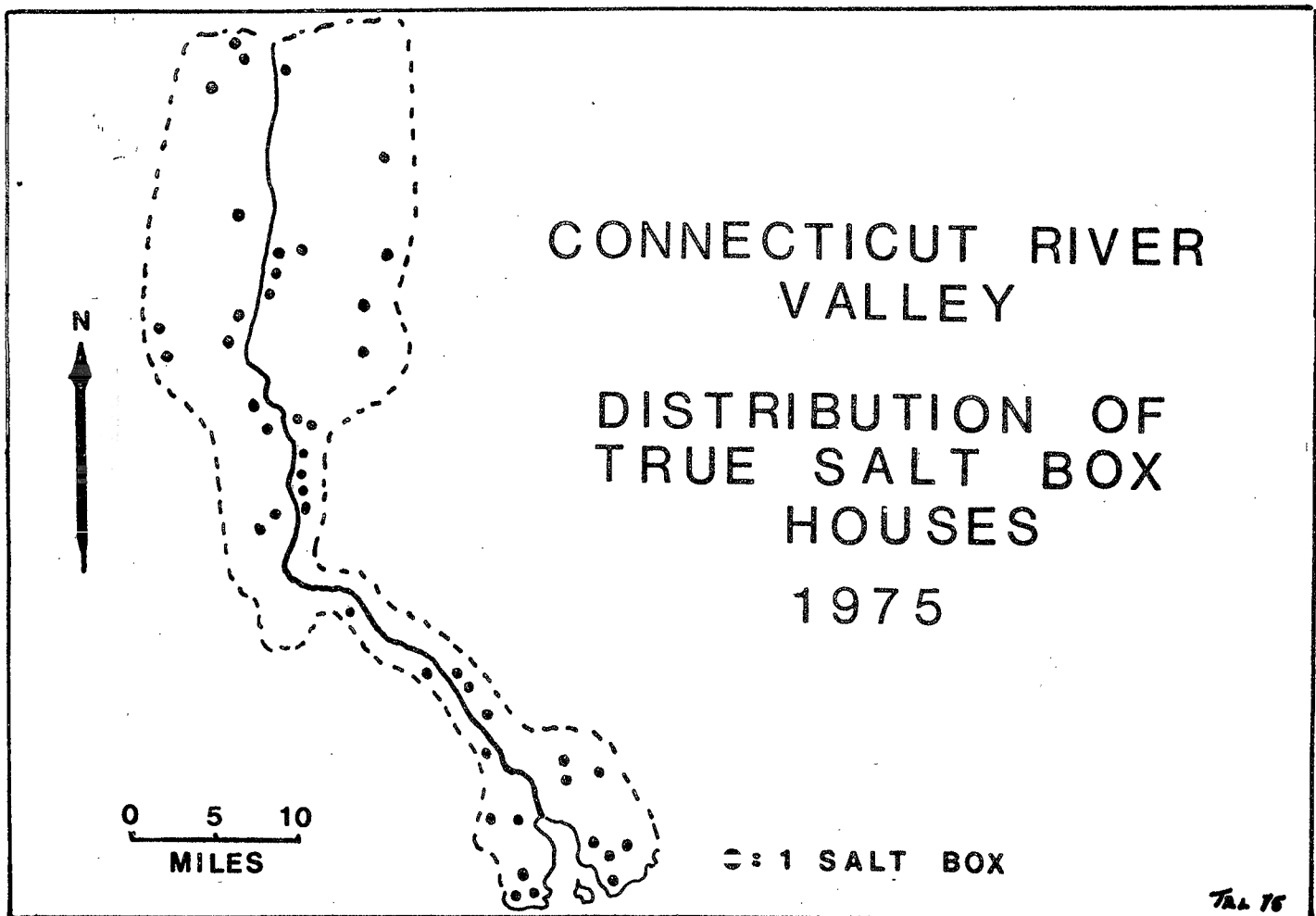

Figure 1





Lewis Jr. 1976



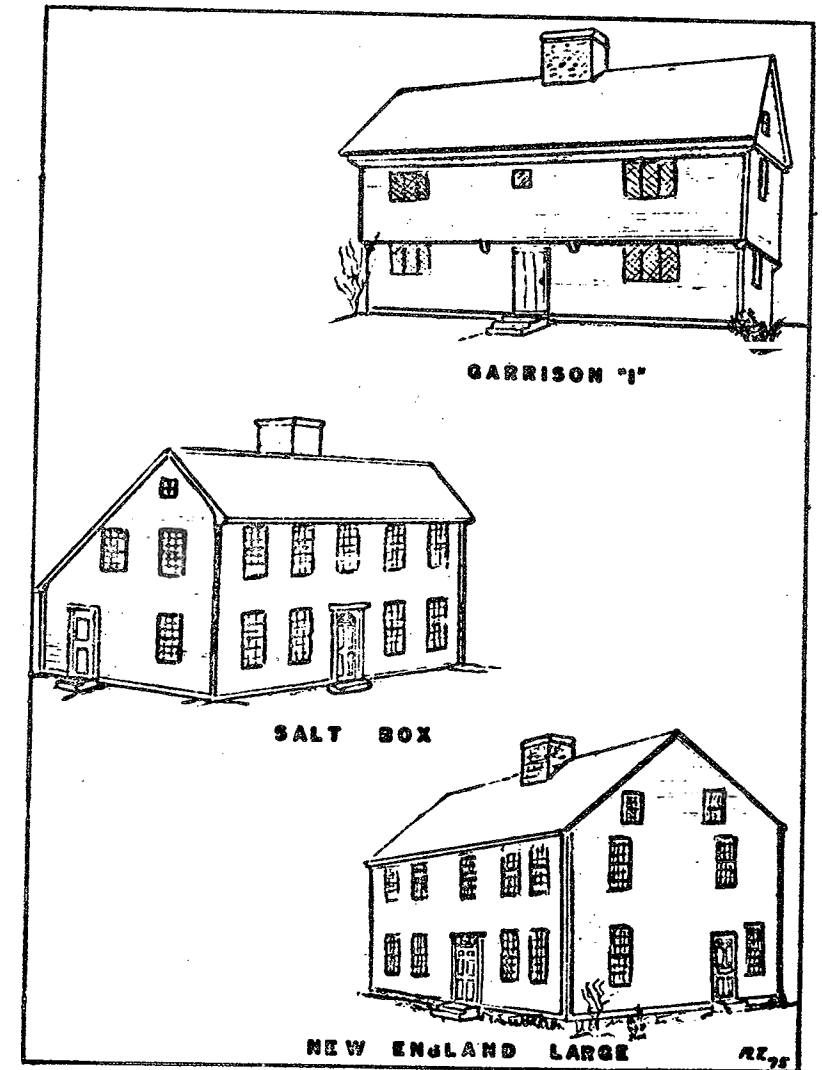
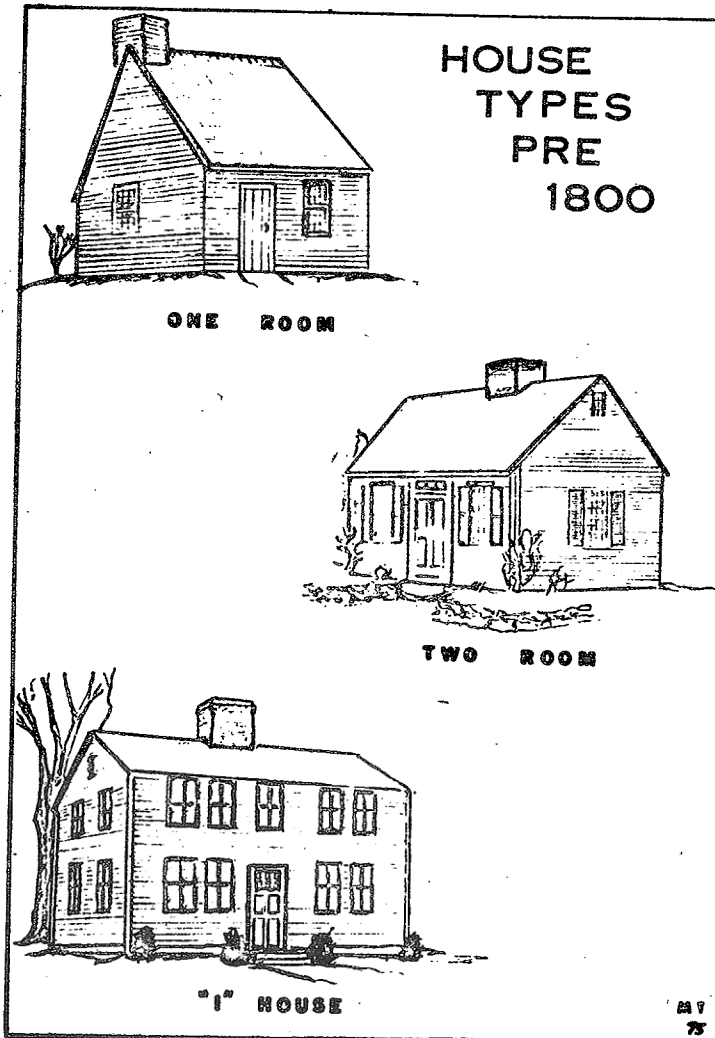

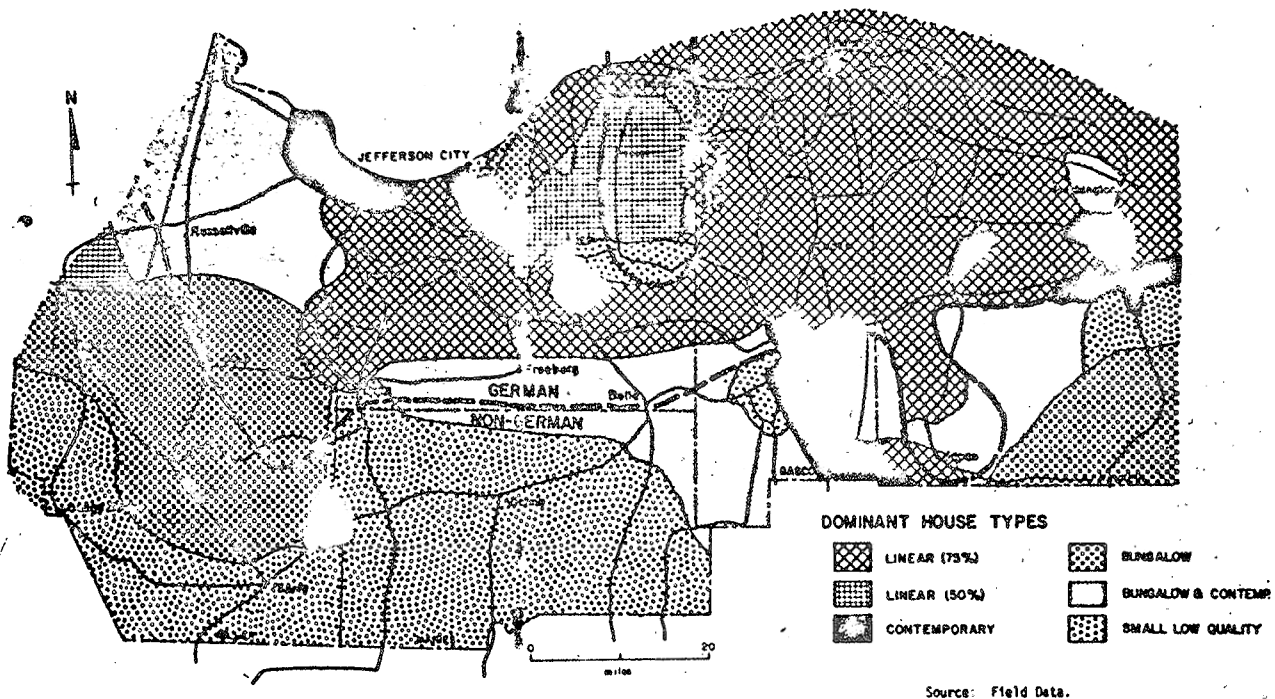
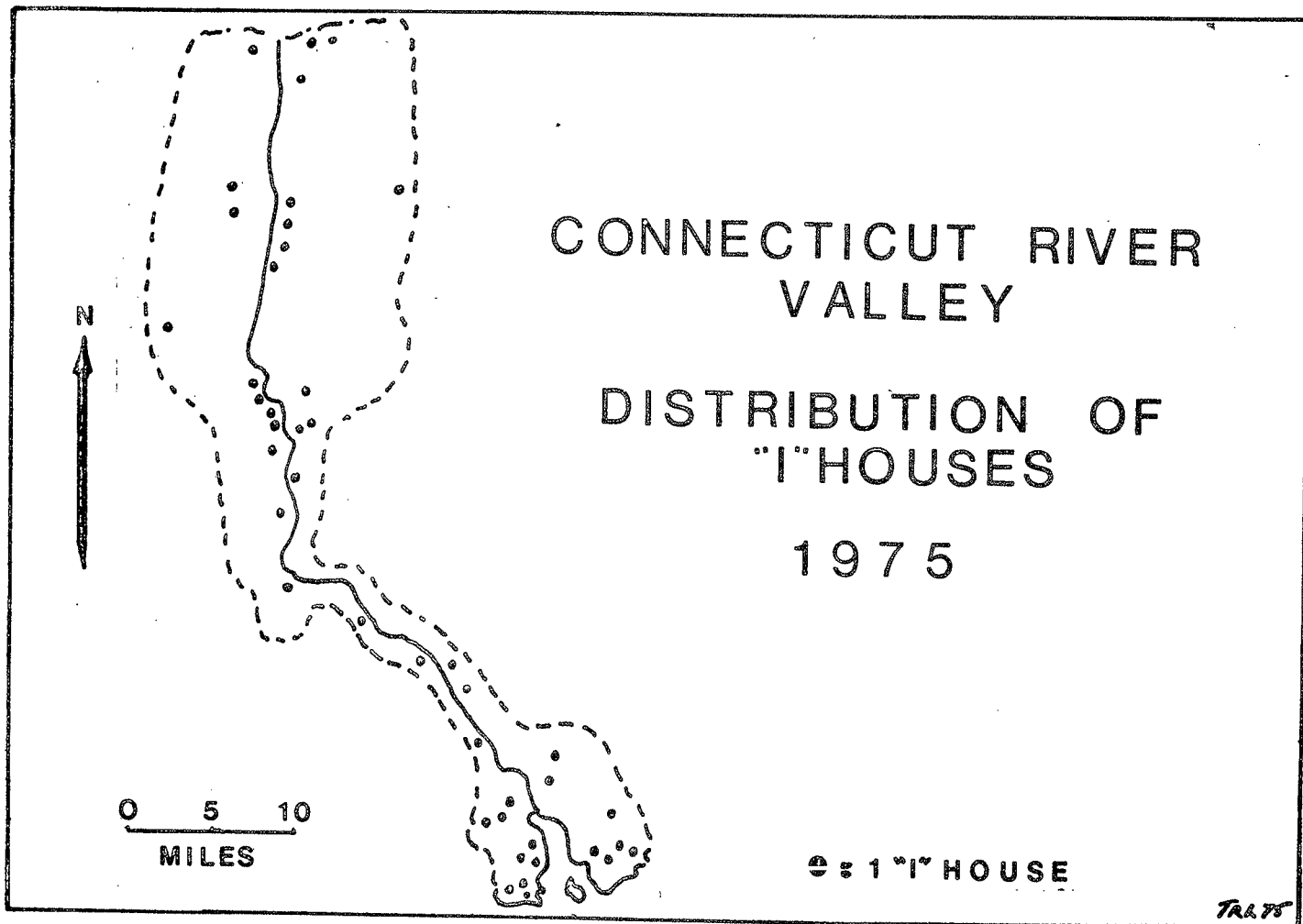

Figure 60. Generalized House Types in the Northern Ozark Border Traverse Area.

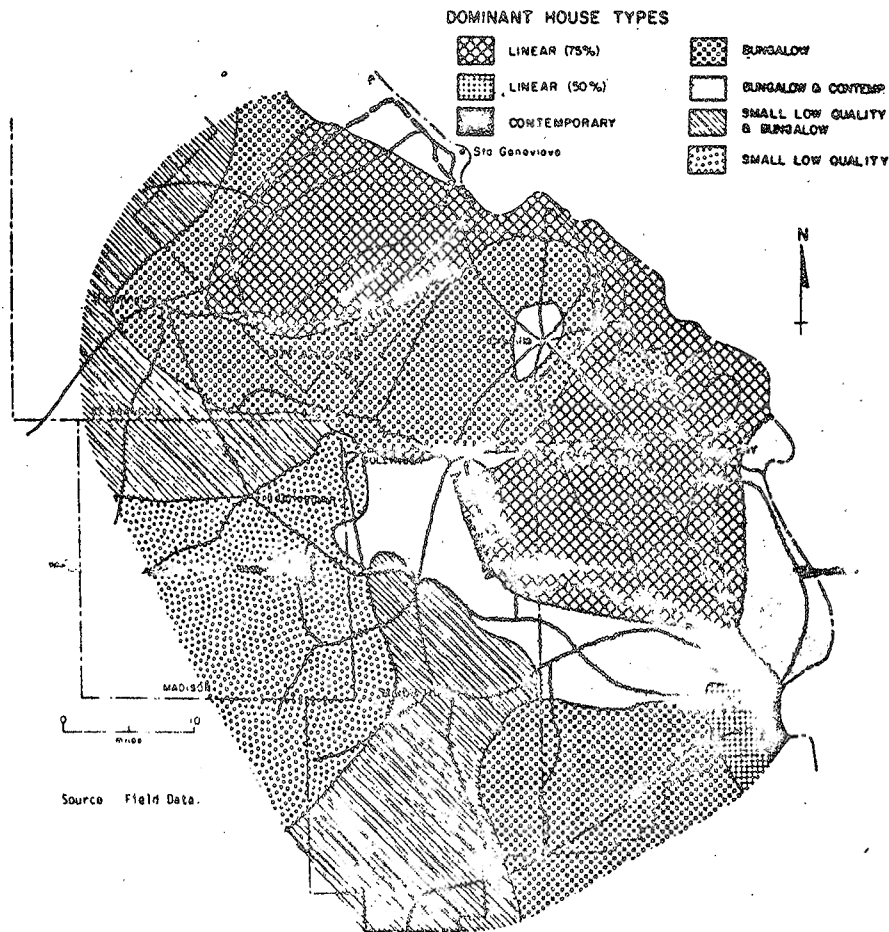
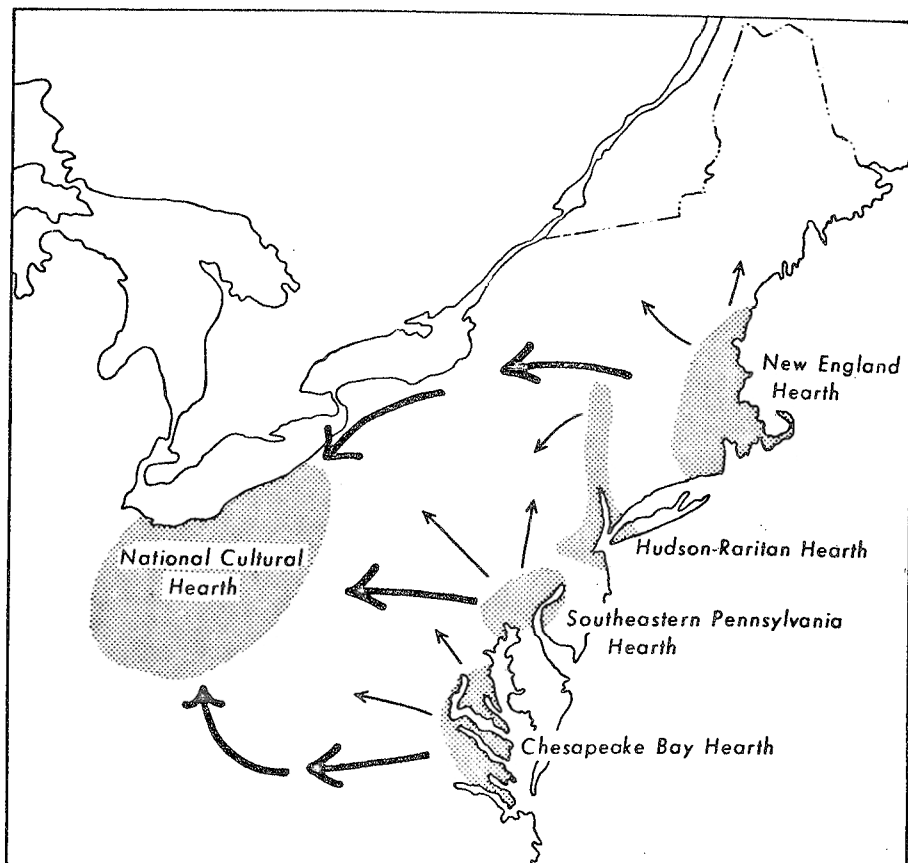

Figure 61. Generalized House Types in the Eastern Ozark Border Traverse Area.

Gerlach 1974



Noble 1975

Fig. 1. The Process of Settlement Landscape Evolution in the Northeastern United States

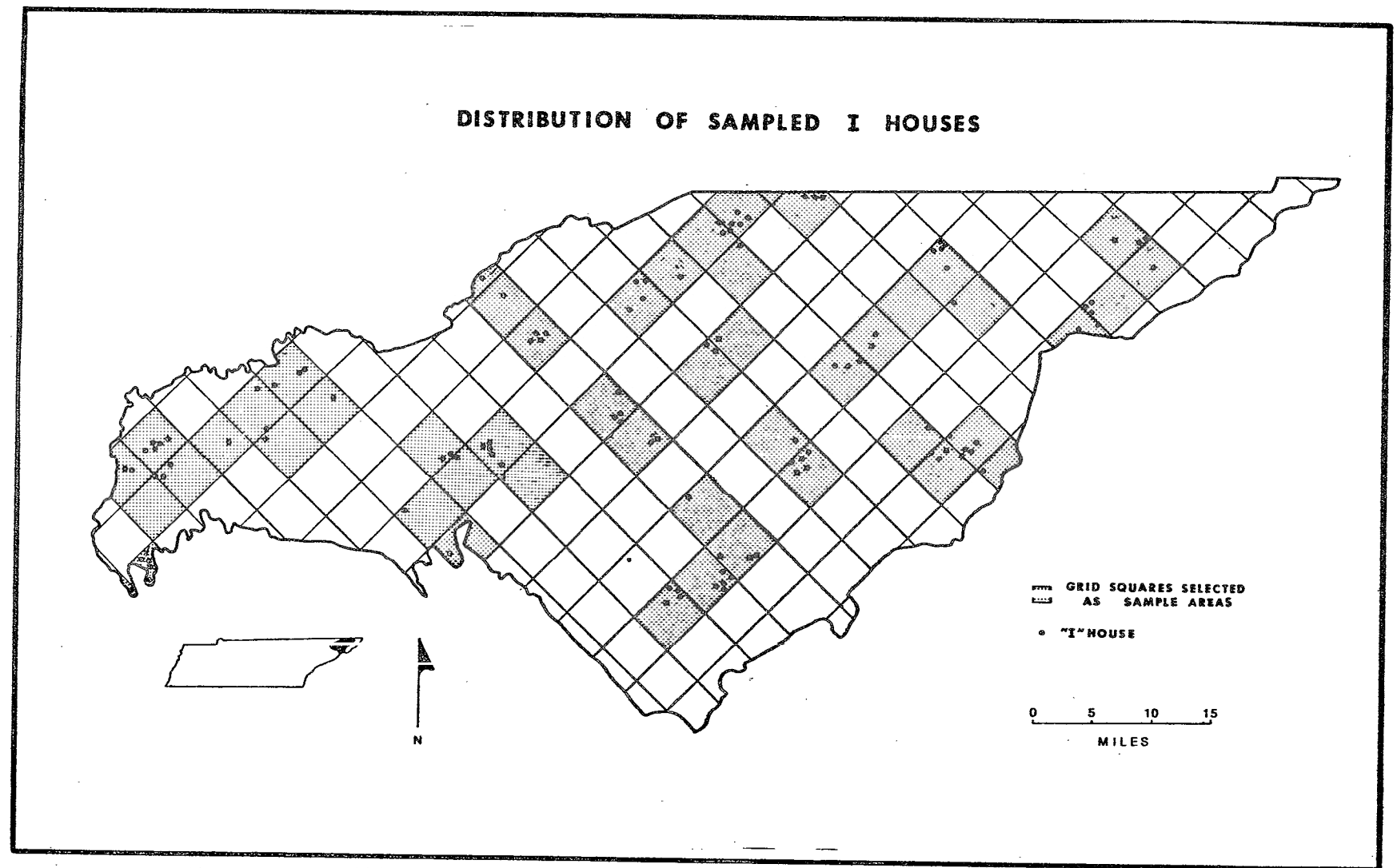
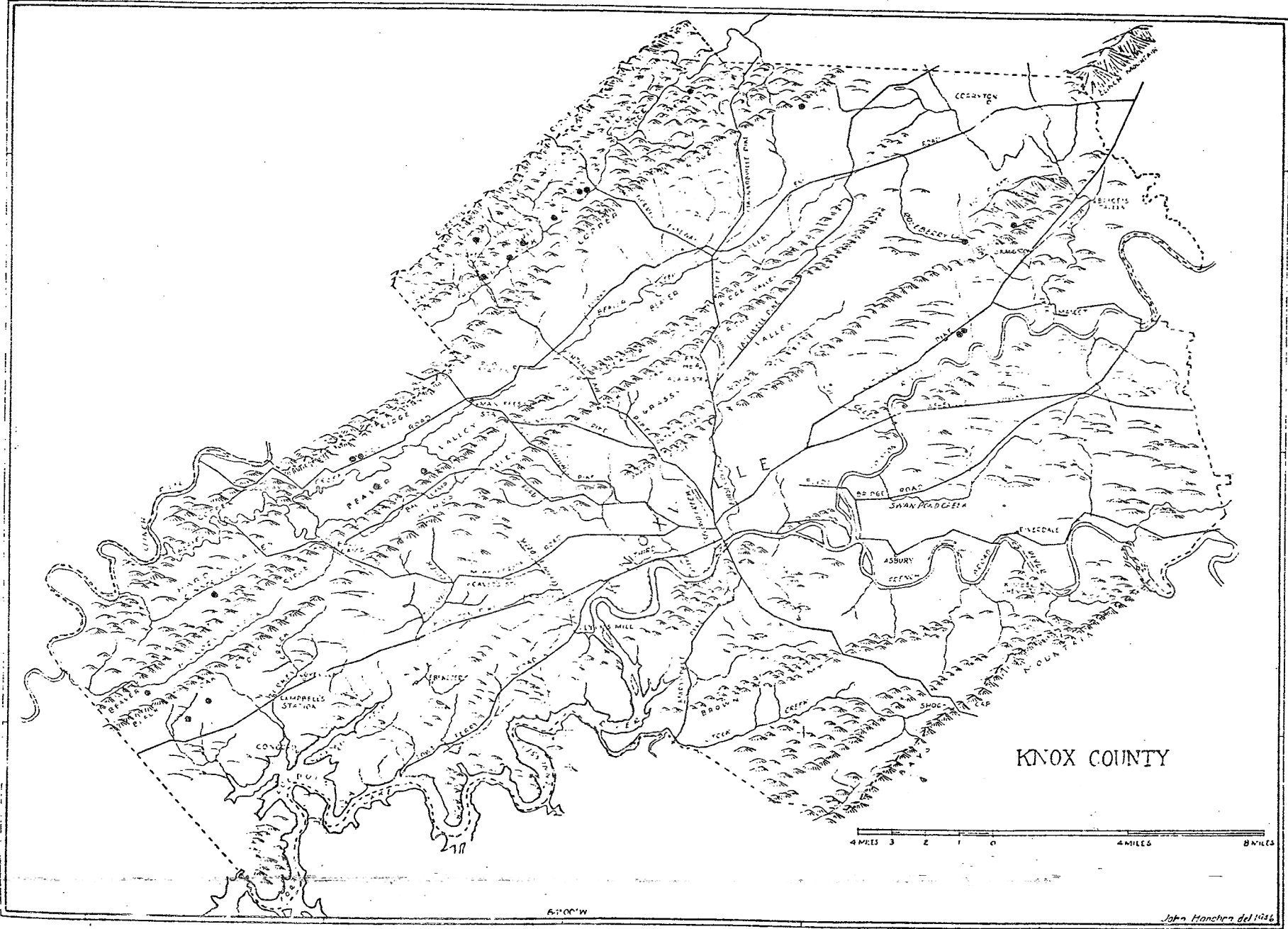

Figure 3. Distribution of sampled "I" houses.

O'Malley 1972

Johnson 1975



Map 3. Central Chimney "I" Houses

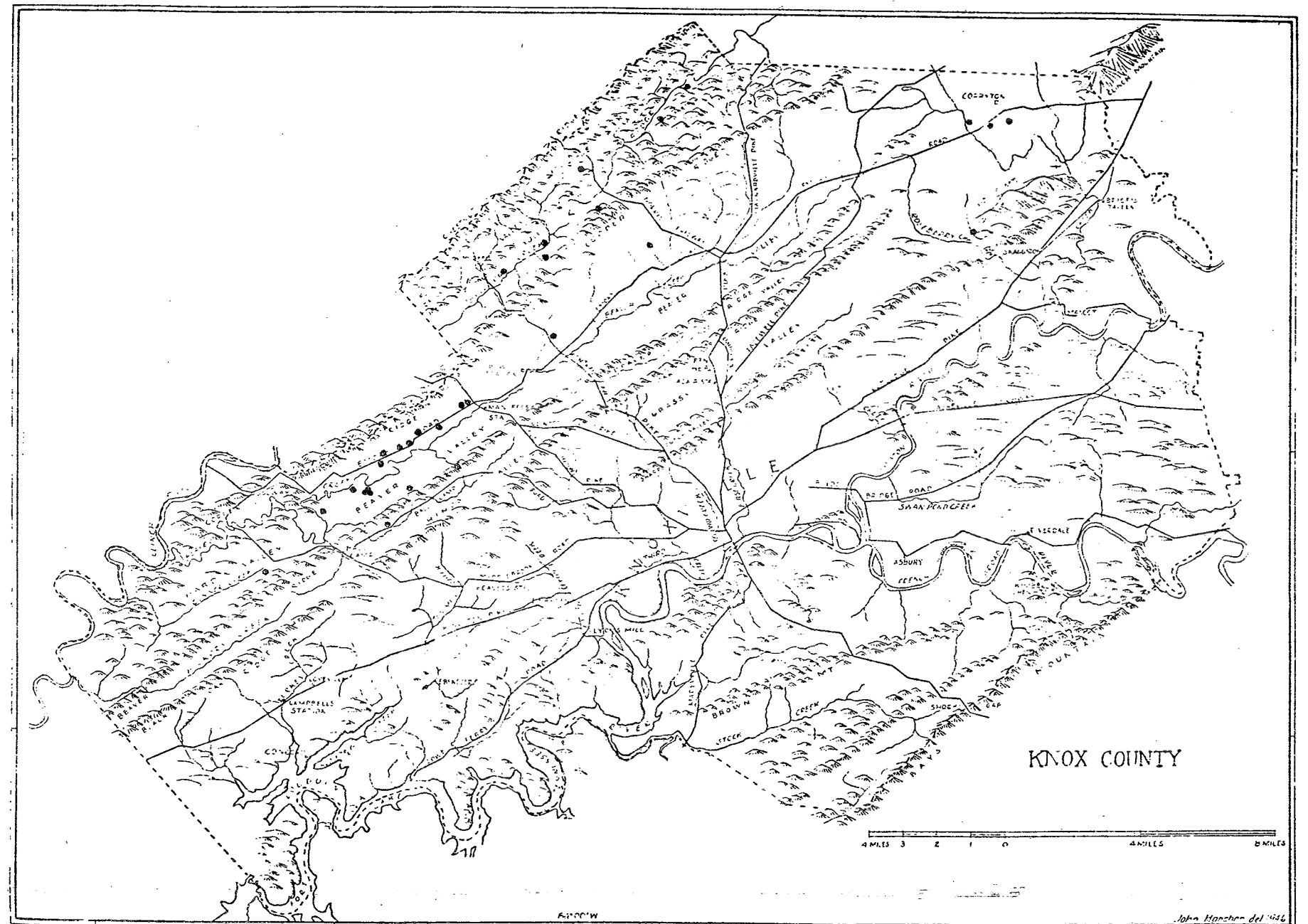

Map 2. End Chimney "I" Houses

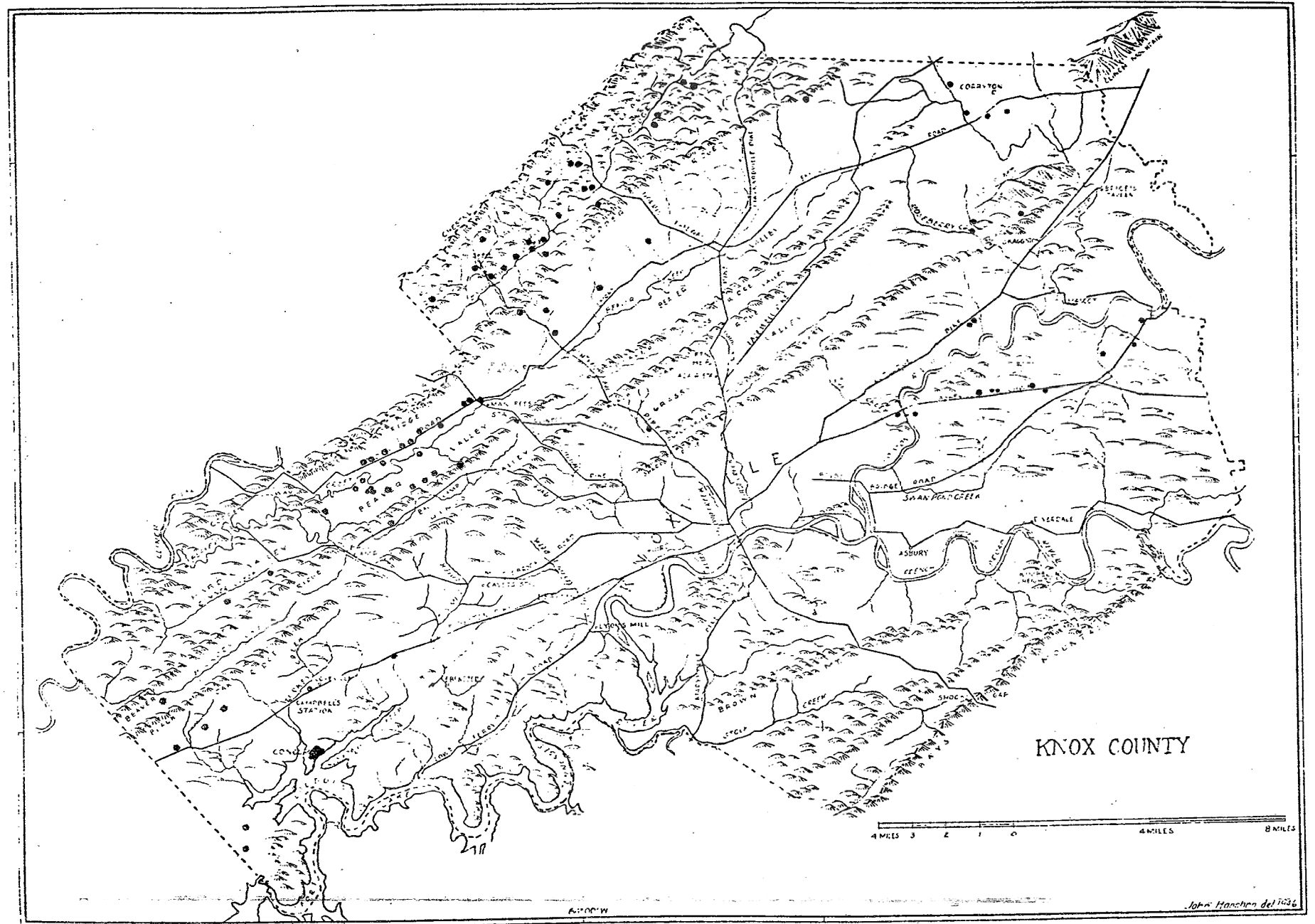

Map 1. "I" Houses found in Knox County



LOG STRUCTURES and EARLY ROADS

CUMBERLAND COUNTY, TENNESSEE

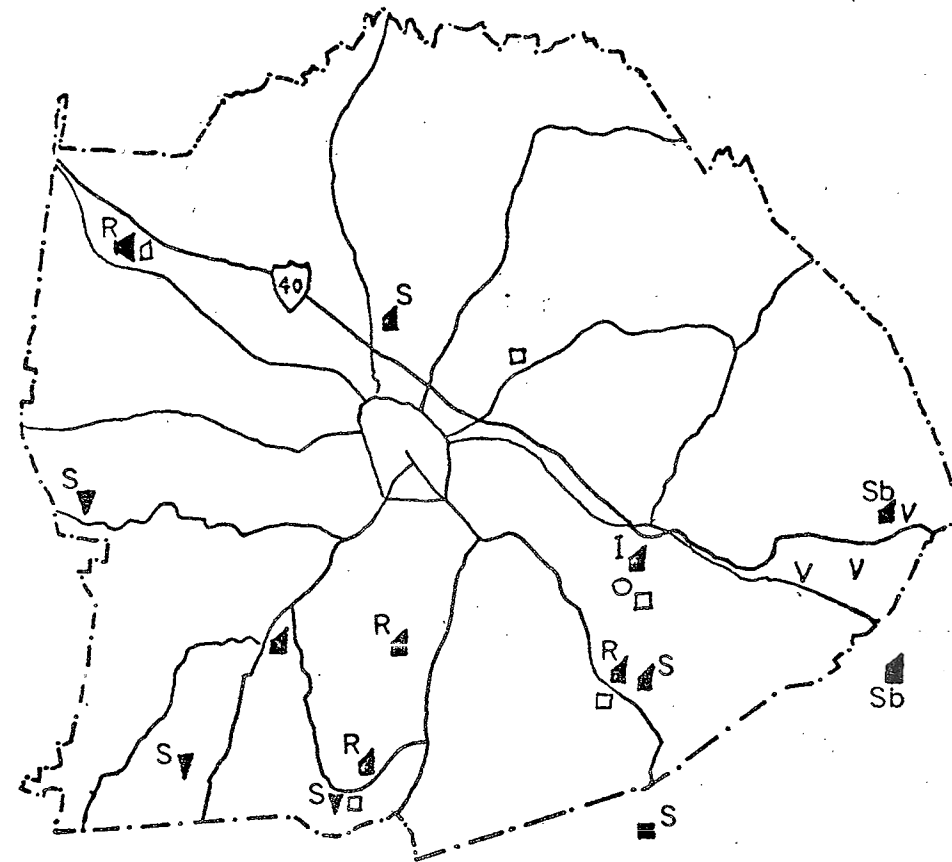

- | | |
|-----------------|------------|
| ▲ Dovetail | ▼ V-Notch |
| ▲ Half-Dovetail | ■ Square |
| □ Outbuilding | ● Dwelling |
| Sb Saddlebag | |

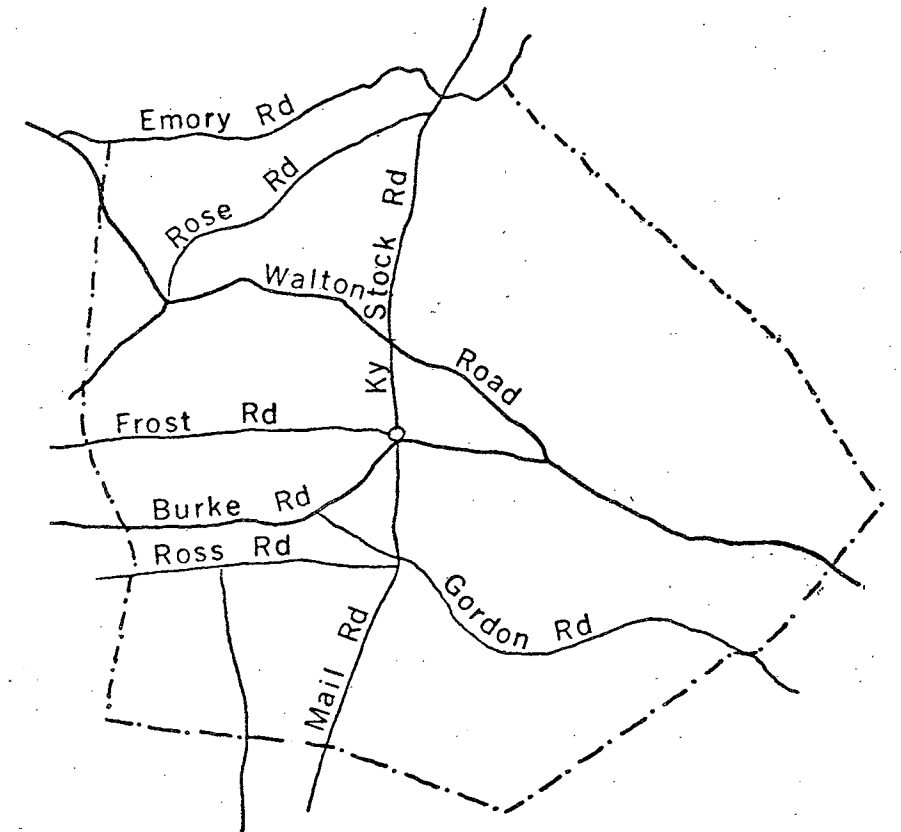

EARLY ROADS

Smith 1970

TYPES DE MAISONS DU RANG SAINT-JACQUES

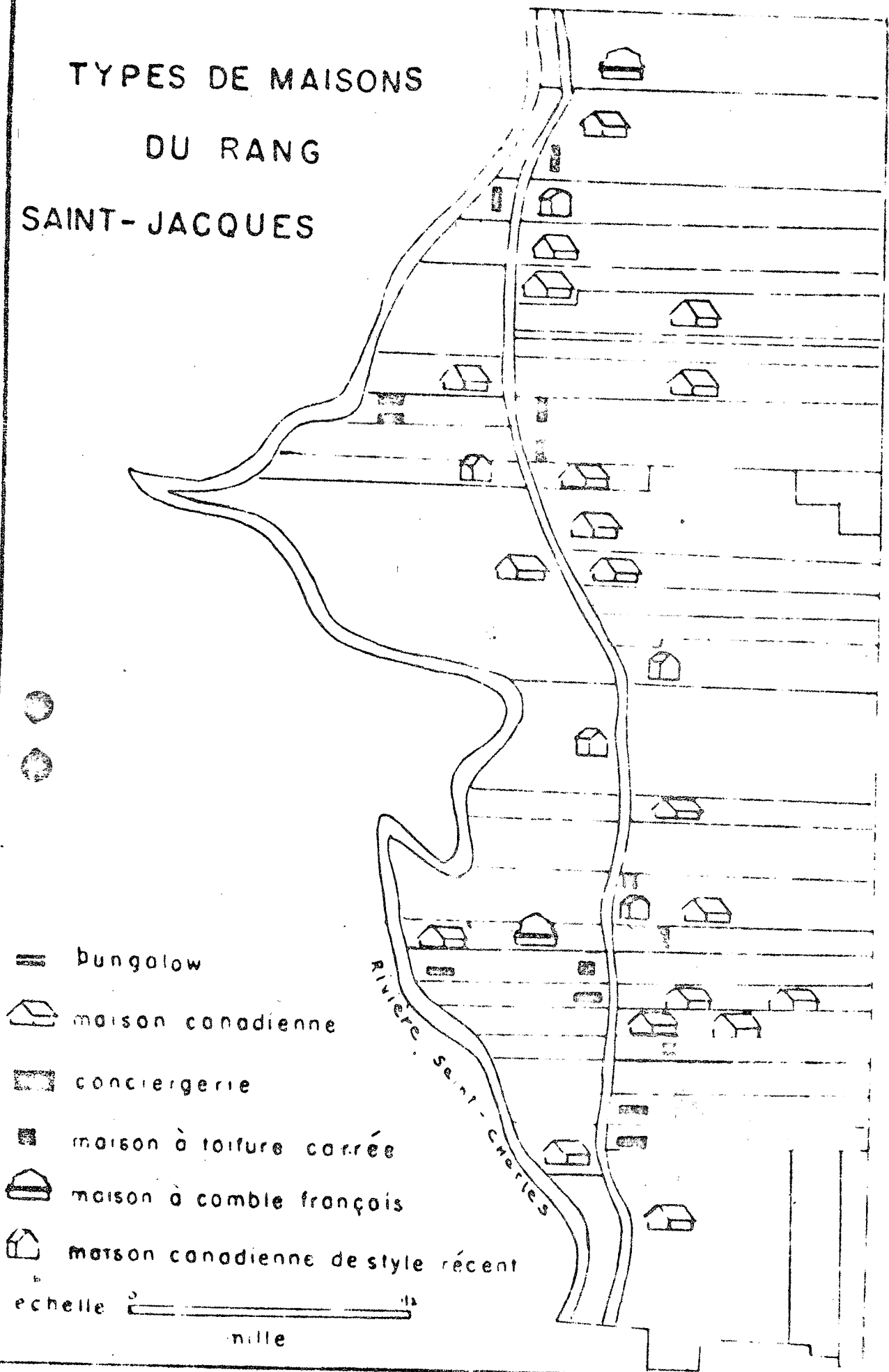

Single and Double Crib - TYPE B Barns

Sherherd 1975

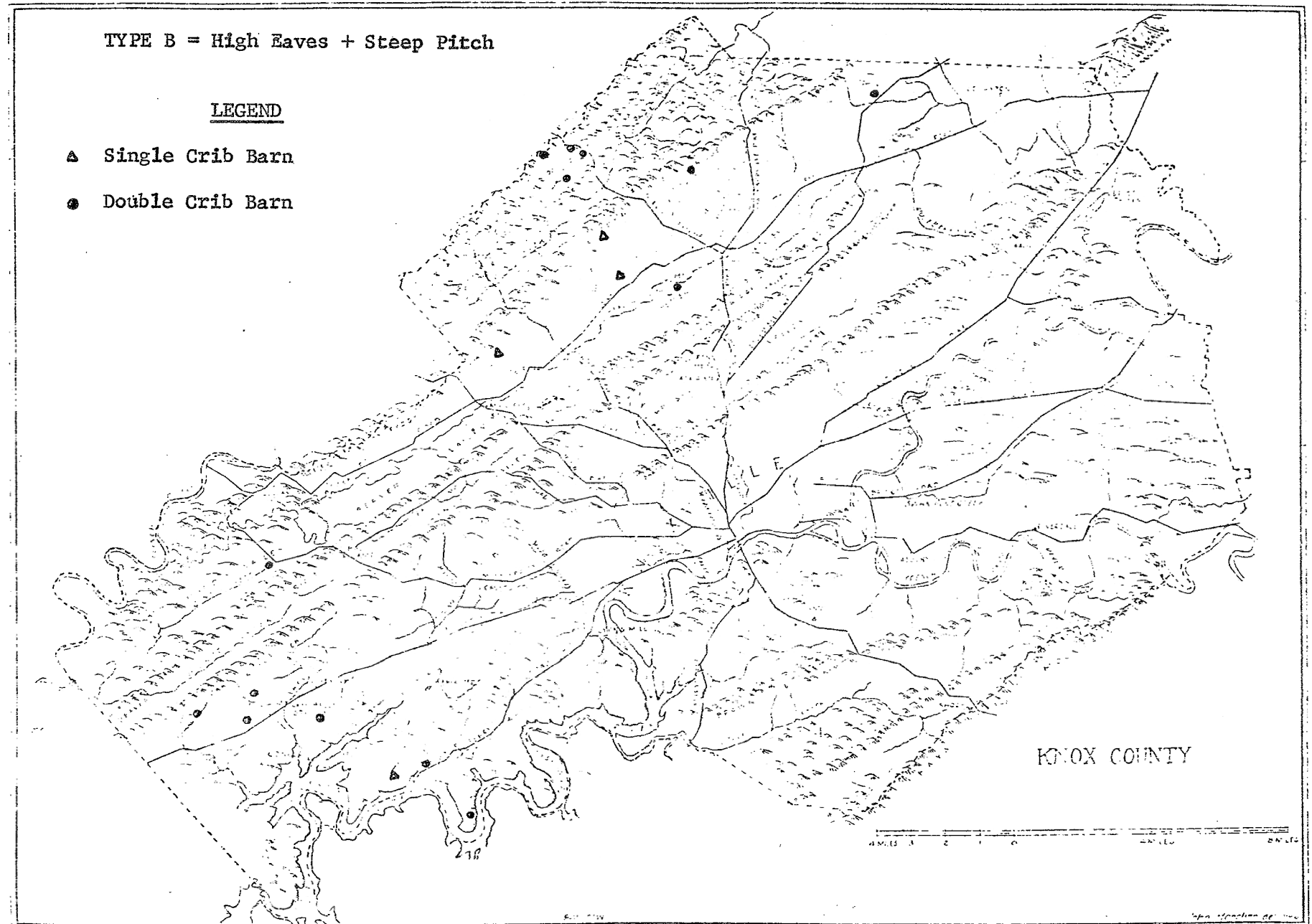

Six Crib - TYPE A Barns

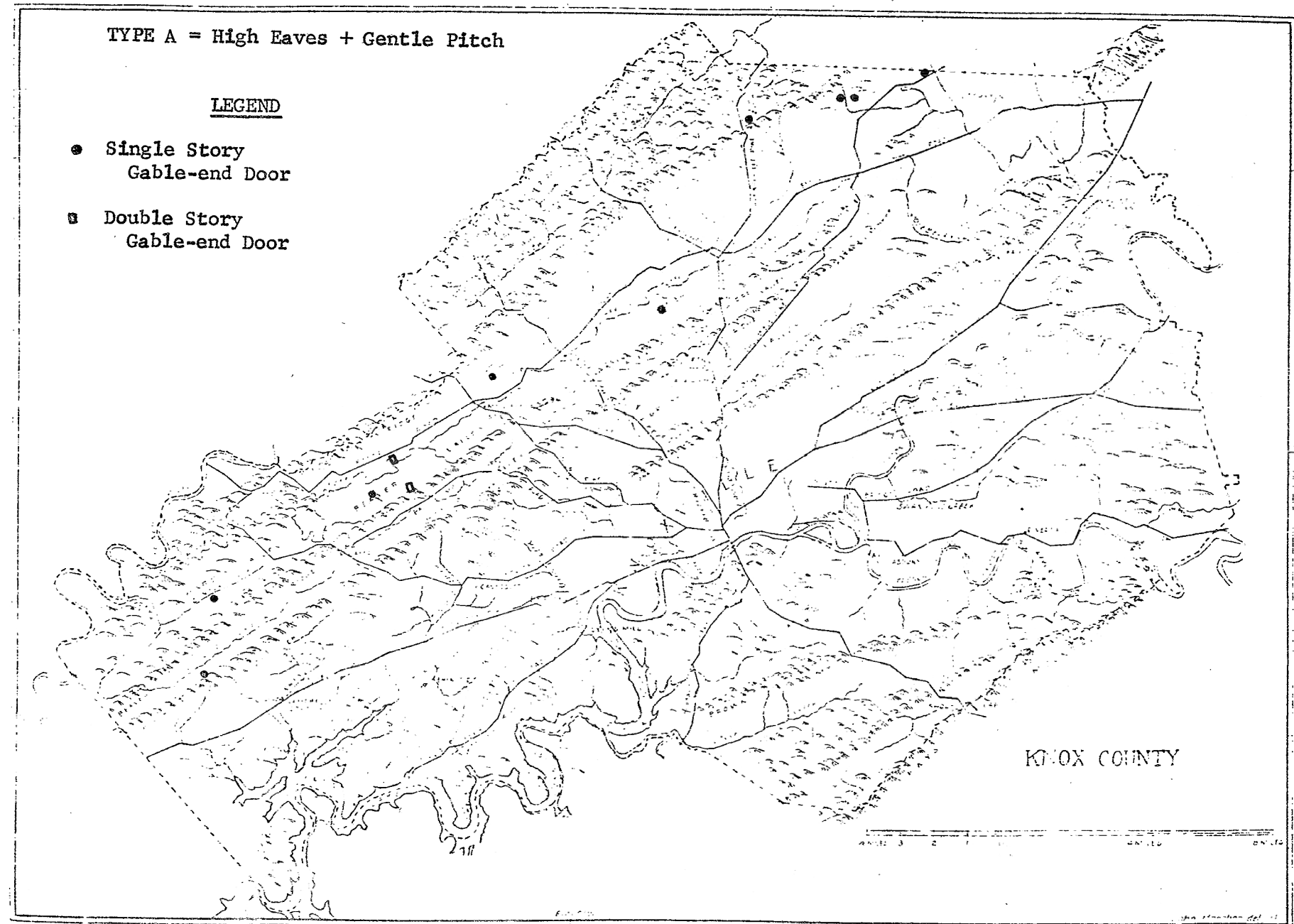

Four Crib - TYPE A Barns

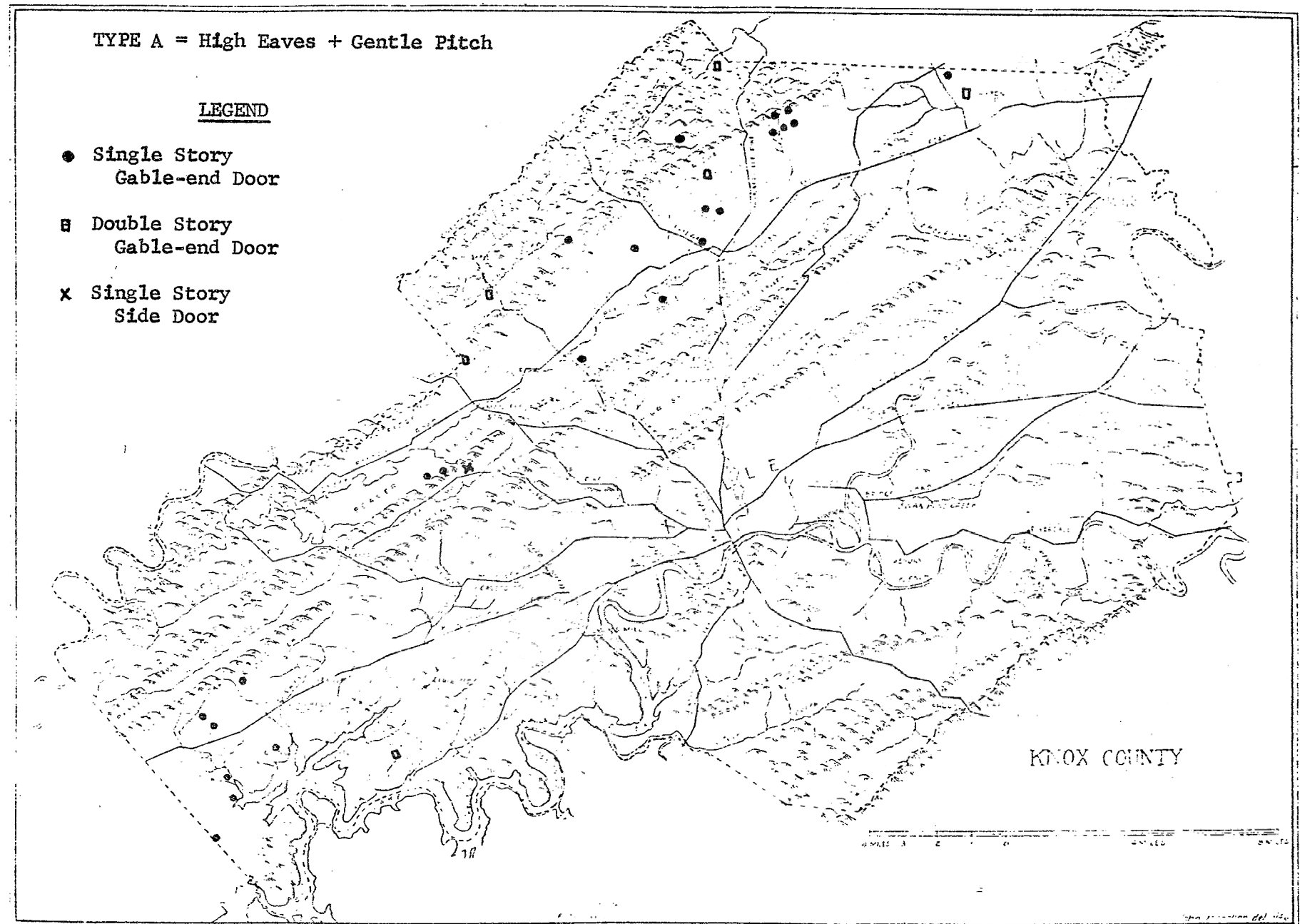

Two and Three Crib - TYPE A Barns

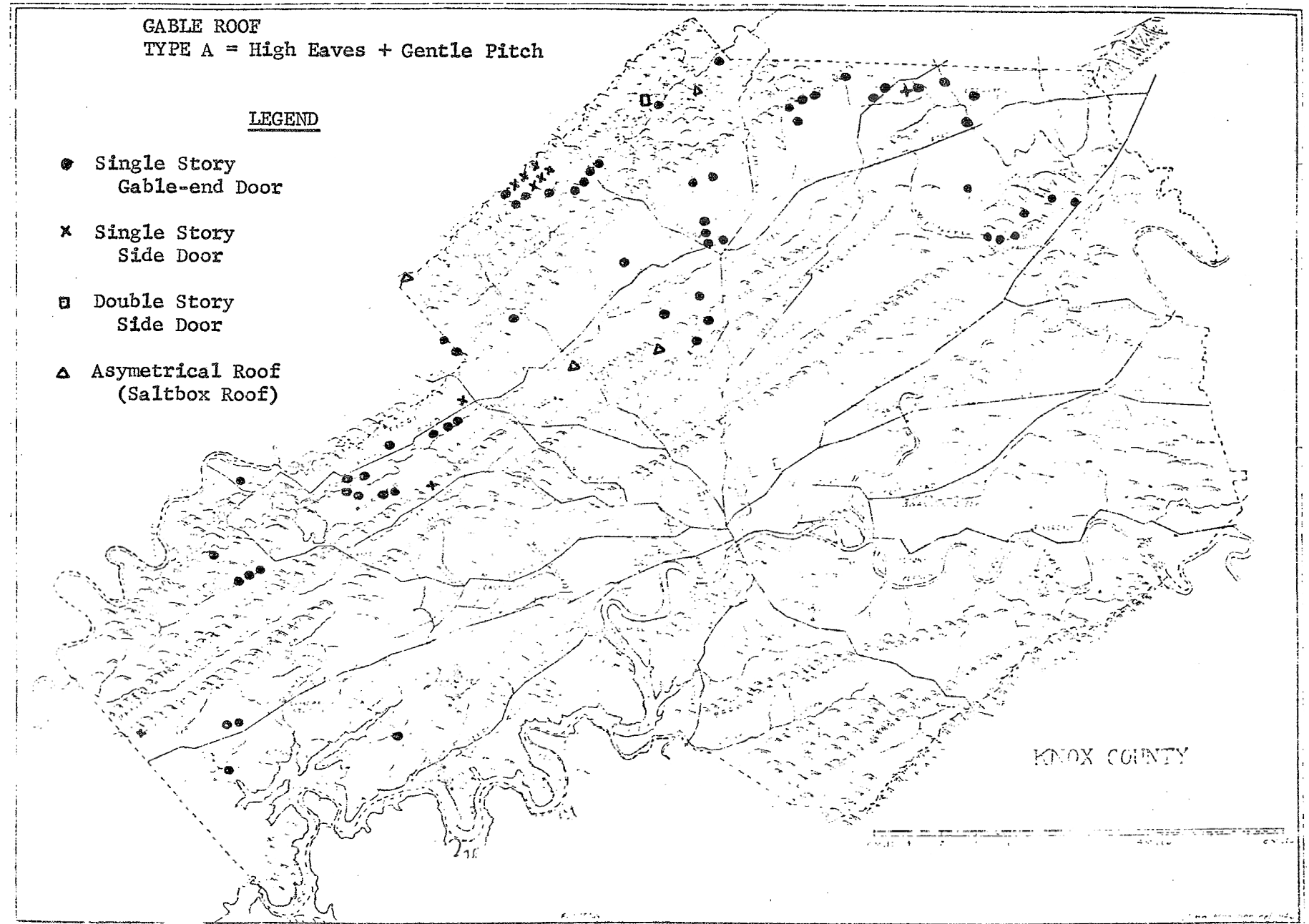

GENERAL ROOF TYPES

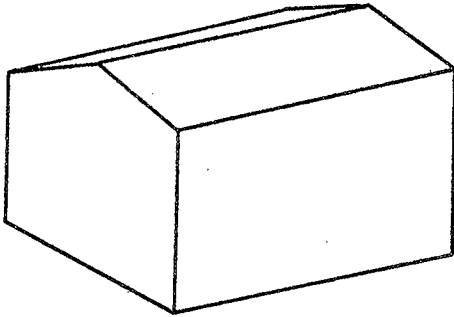

TYPE A - GABLE ROOF
HIGH EAVES + GENTLE PITCH
(ENGLISH STYLE)

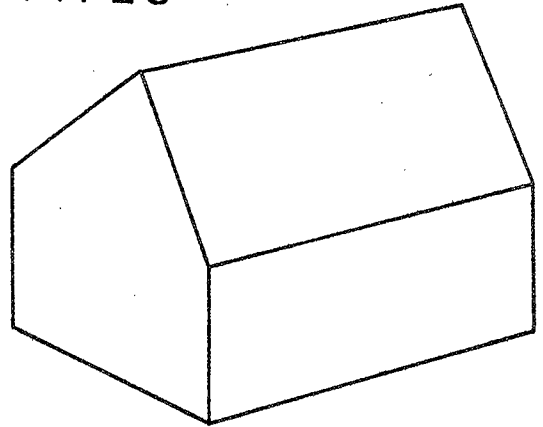

TYPE B - GABLE ROOF
HIGH EAVES + STEEP PITCH
(GERMAN STYLE)

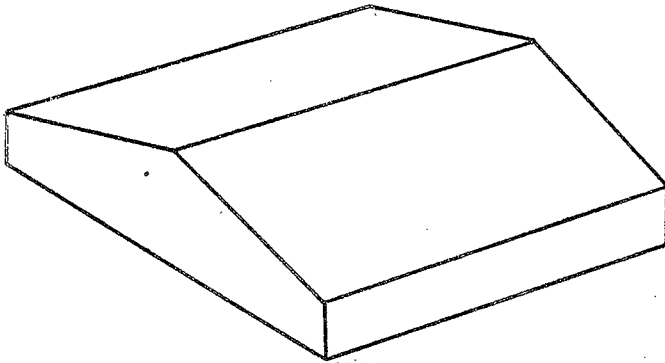

TYPE C - GABLE ROOF
LOW EAVES + GENTLE PITCH
(Western Style)

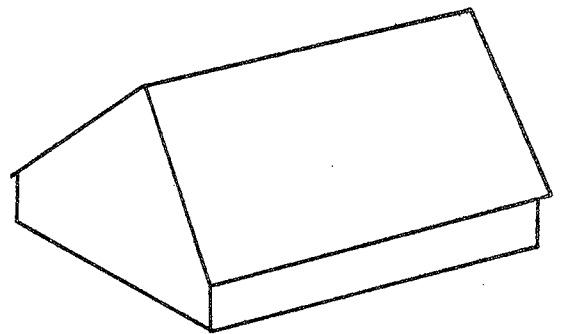

TYPE D - GABLE ROOF
LOW EAVES + STEEP PITCH
(Dutch & French Styles)

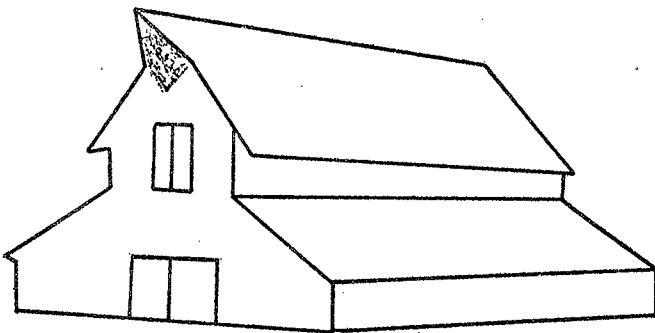

Variation of TYPE C - GABLE ROOF
(Broken Gable Western)

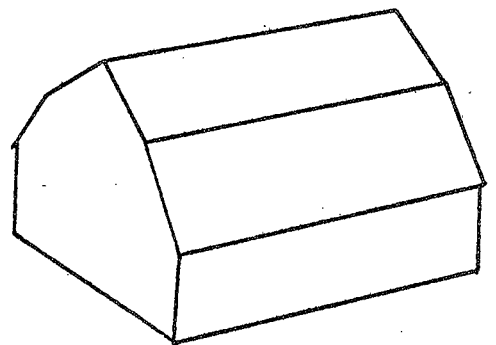

STANDARD (English) GAMBREL

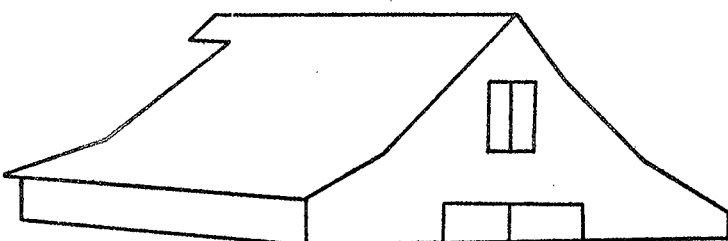

Variation of TYPE C - GABLE ROOF
(Straight Gable Western)

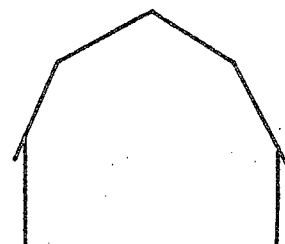

End View
STANDARD GAMBREL

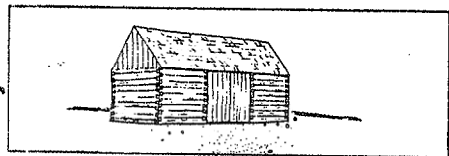

Three Bay Log Barn

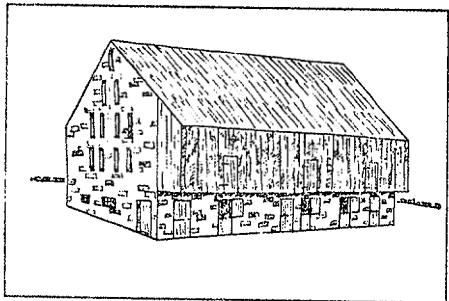

Pennsylvania Forebay Barn

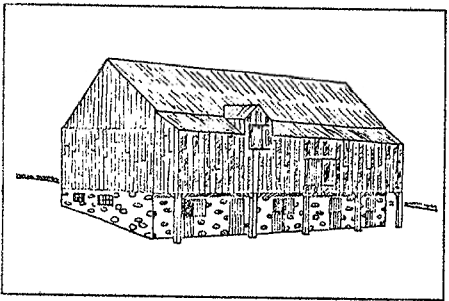

Wisconsin Porch Barn

Figure 2.

Bastian 1975

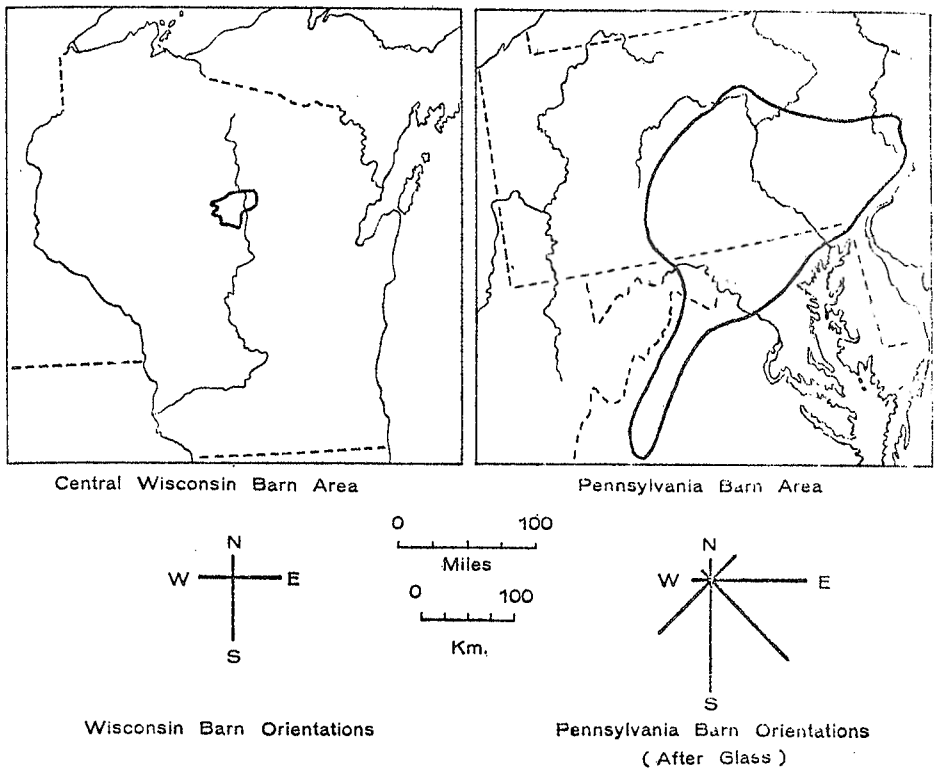

Figure 1.

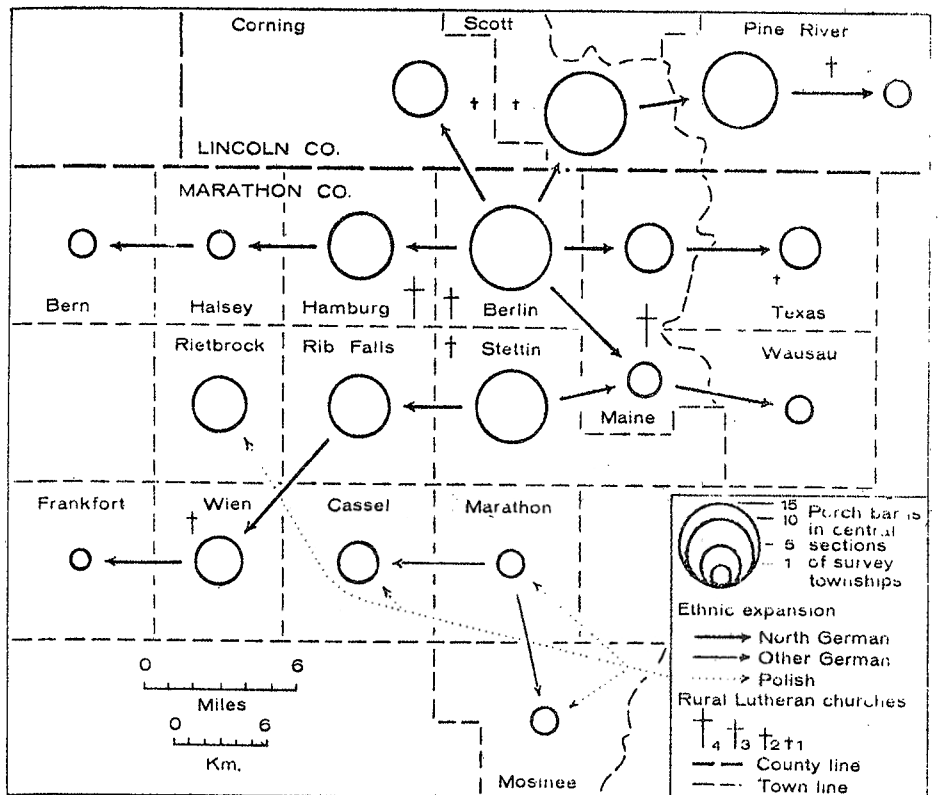

Figure 3. Model of Agrarian Settlement by Distinct Cultural Groups in Central Wisconsin.

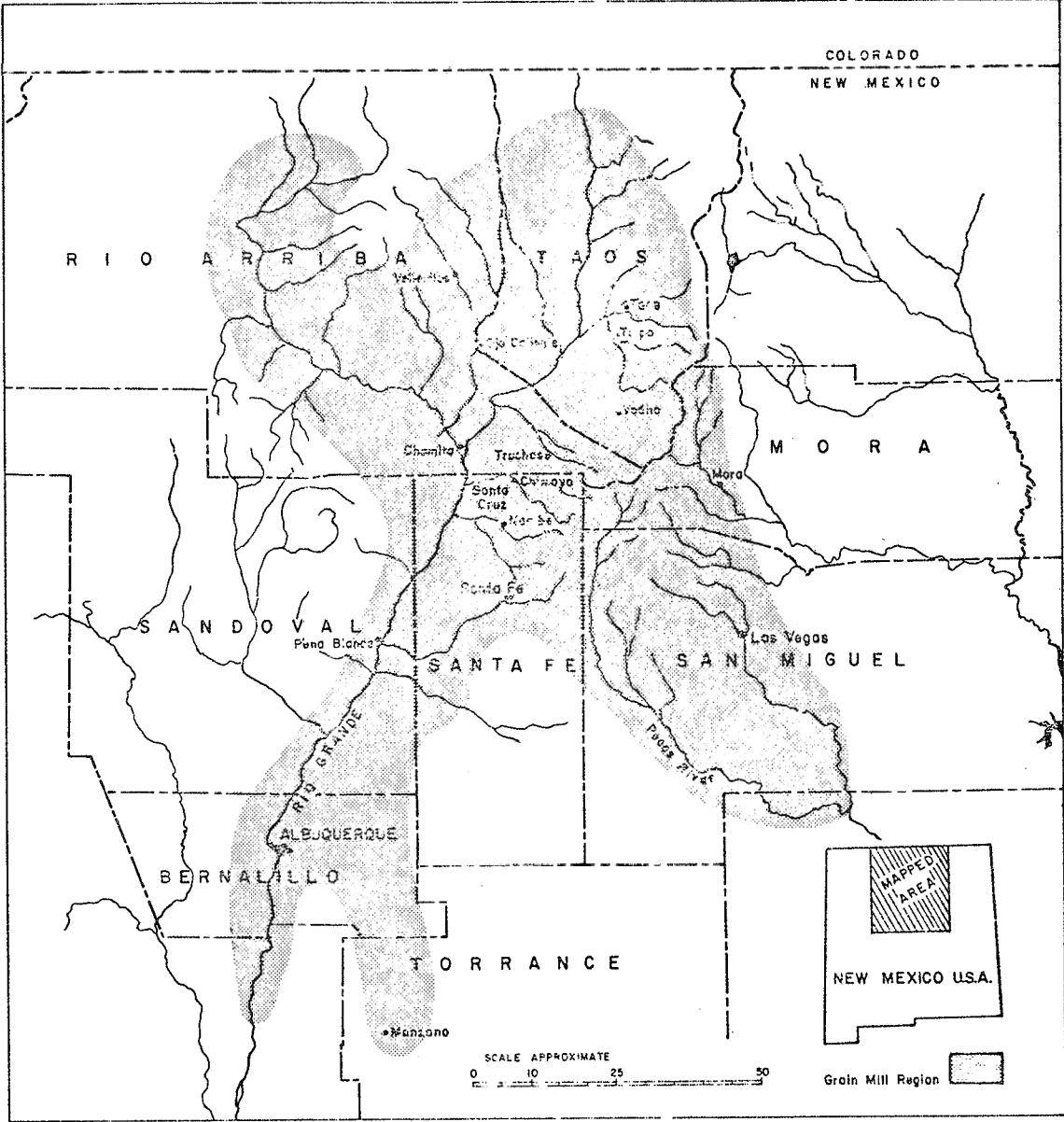

FIG. 6. Probable distribution of Hispano gristmills in New Mexico during the nineteenth century.

Gritzner 1974

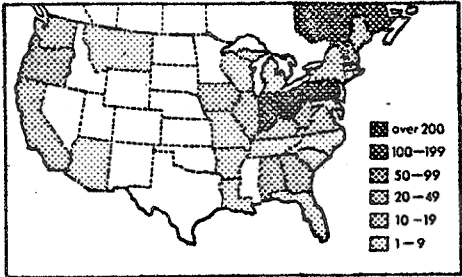
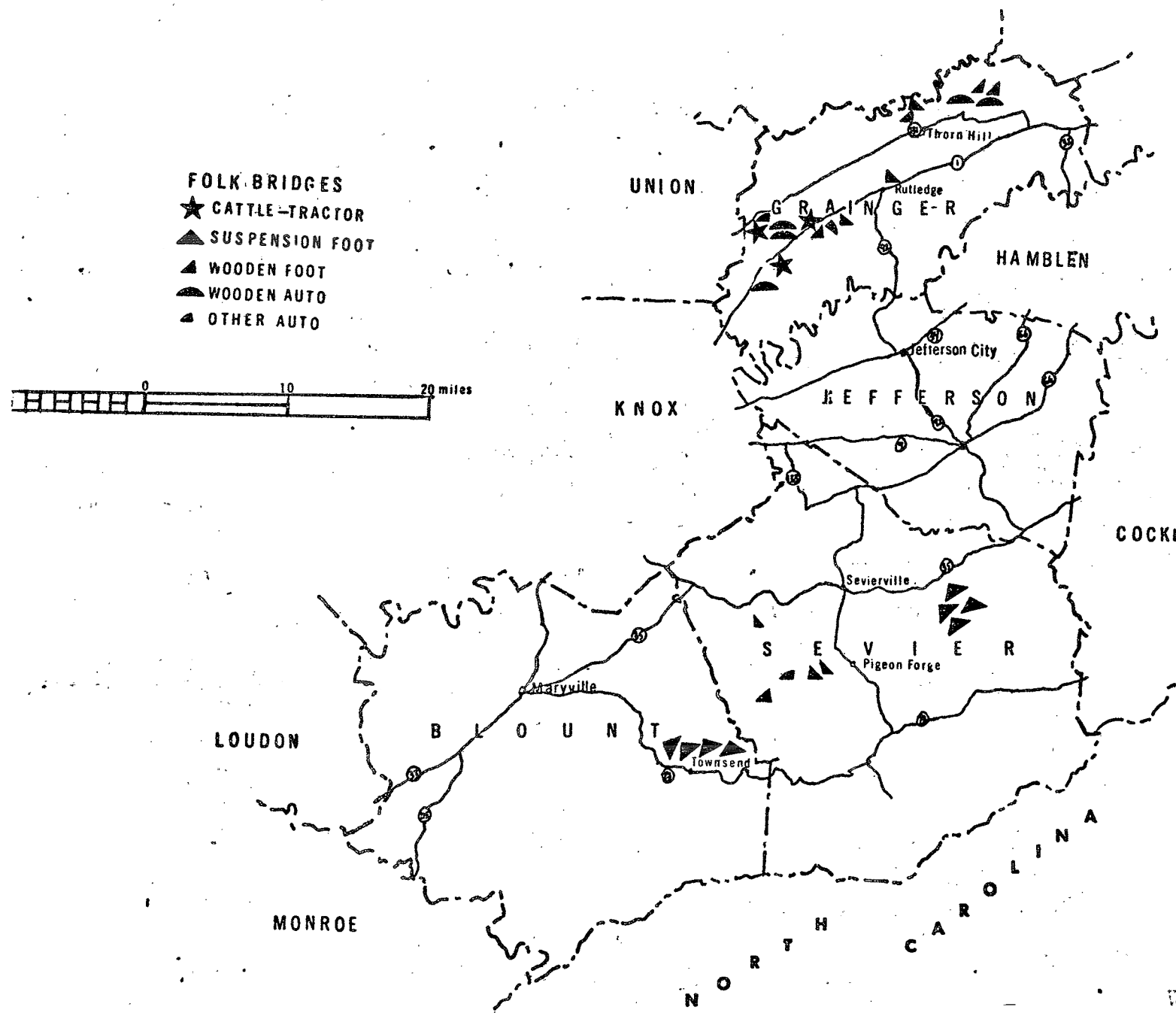

Figure 1. Distribution of covered bridges in Anglo-

Gildea 1971



Weber 1973

UNIVERSITY OF TENNESSEE		
SCALE: 1:500,000	DATE:	DRAWN BY: Charles Weber